

**COVER FOR OFFICIAL FILE**  
**SCHOOL DISTRICT BOUNDARY APPEAL BOARD**

---

**File No:** 2019-10  
**From:** Hudson School District  
**To:** River Falls School District  
**Appellant(s):** Ryan and Heidi Van Nurden  
**Address:** 346 South Glover Road  
River Falls, WI

**SDBAB Hearing**

**Date:** 5/29/2019  
**Time:** 12:30 PM  
**Location:** GEF 3 - Room P41  
125 South Webster Street  
Madison, WI

**School District Boundary Appeal Panel (Board) Members:**

1. David Amundson (small)
2. Robert Morehouse (medium)
3. Thomas P. Weber (large)

**Chair: Janice Zmrazek**



**MATERIALS  
FROM  
PETITIONER**



19-10

Example form provided by DPI

# PETITION TO ALTER SCHOOL DISTRICT BOUNDARIES

Detachment and Attachment of Small Territory - see section 117.12, Wisconsin Statutes

The petitioner should complete Section 1, take the form to the municipal clerk to complete Section 2, and then submit the petition to the school district where the property is located. See [http://sms.dpi.wi.gov/sms\\_rgsmallo](http://sms.dpi.wi.gov/sms_rgsmallo) on the Internet for more information. The petition must be submitted to the school district **BEFORE FEBRUARY 1**.

## SECTION 1 - TO BE COMPLETED BY THE PERSON SUBMITTING THE PETITION

(please print or type)

Petitioner Name(s) RYAN VAN NURDEN AND HEIDI VAN NURDEN

Address (street, city, zip) 346 S GLOVER ROAD, RIVER FALLS, WI 54022

Phone Number 612-282-8524 E-mail RYANMETRO@AOL.COM

Legal Description of Territory Proposed for Detachment INCLUDING PARCEL NUMBERS: \_\_\_\_\_

PARCEL # 040-1066-60-001 SEC 16 T28N R19W NE SE BEING CSM 27-6158 LOT 1

PARCEL # 040-1066-60-002 SEC 16 T28N R19W PART OF NE SE AND NW SE BEING CSM 27-6158 LOT 2

(If more space is needed to describe the property, attach additional pages)

I/we, the undersigned, representing 50% of the owners or a majority of electors owning or residing on the above described territory, file this petition to detach the above described territory **FROM** the HUDSON School District and to attach it **TO** the RIVER FALLS School District.

SIGNATURE(S)	DATE	(For each signature check one)		
		Property Owner	Elector	Both Owner and Elector
1. <i>[Signature]</i>	12-26-18			X
2. <i>[Signature]</i>	12-26-18			X

## SECTION 2 - TO BE COMPLETED BY THE CLERK OF THE MUNICIPALITY IN WHICH THE TERRITORY IS LOCATED - (please print or type)

The legal description of the territory proposed for detachment is sufficient to identify its location and value. (If no, return the form to the petitioner.) YES  NO

School District where territory is located	<u>River Falls Hudson</u>	Value of Property	<u>\$666,900<sup>00</sup></u>
Municipality where territory is located	<u>Town of Trapp</u>	Year Value was Determined	<u>2018</u>
County where territory is located	<u>St. Croix</u>	Assessment Ratio	<u>.9089</u>

I, the undersigned, certify that the property description in Section 1 is sufficient to determine its location and value and that the information entered above in Section 2 is correct.

SIGNATURE OF MUNICIPAL CLERK Jennifer Clark Date: 12/27/2018

Name of Clerk (please print) Jennifer Clark

Mailing Address 654 Glover Road

Phone Number 715-425-2105 E-mail Address towntrapp@baldwin-tekcom.net

## SECTION 3 - TO BE COMPLETED BY THE CLERK OF THE SCHOOL DISTRICT IN WHICH THE TERRITORY IS LOCATED - (please print or type)

District receiving petition School District of Hudson Date received 12/27/2018

Number of pupils residing in the territory described in Section 1 who were enrolled in the district as of the most recent 3<sup>rd</sup> Friday in September or 2<sup>nd</sup> Friday in January (see s.121.05 (1) (a), Wisconsin statutes). 0

Name of School District Clerk (please print) Carrie Whitacre Phone 715-377-3702

SIGNATURE OF SCHOOL DISTRICT CLERK [Signature]

After completing Section 3 the clerk of the detaching school district must send a certified copy (a document with original signatures or a photocopy accompanied by a Certificate of True Copy) of this petition to the school board of the school district to which the property is proposed to be attached and also to :

Secretary, School District Boundary Appeal Board  
Department of Public Instruction  
PO Box 7841  
Madison, WI 53707-7841

JAN - 9 2019  
WI DPI - SMS  
JZ ✓  
2/15



Example form provided by DPI

# PETITION TO ALTER SCHOOL DISTRICT BOUNDARIES

Detachment and Attachment of Small Territory - see section 117.12, Wisconsin Statutes

## Signatures of additional petitioners

19-10

REC'D

JAN - 9 2019

WI DPI SMS

**Instructions:** Each additional petitioner must sign the form, indicate a street address (not a PO box), and identify the municipality (the township, village, or city) where he/she resides. Indicate the date the form is signed. Each petitioner must also identify whether he/she is an owner of the territory proposed for detachment, an elector residing on the territory, or both an owner and resident elector.

I/we, the undersigned, representing 50% of the owners or a majority of electors owning or residing on the territory described on the petition form, file this petition to detach the described territory **FROM** the HUDSON School District and to attach it **TO** the RIVER FALLS School District.

		(For each signature check one)			
Signature:	Municipality:	DATE	Owner	Elector	Both
<i>[Signature]</i> RYAN VAN NURDEN	TOWN OF TROY	12-26-18			X
Address (street, city, zip): 346 S GLOVER ROAD, RIVER FALLS, WI 54022					
<i>[Signature]</i> HEIDI VAN NURDEN	TOWN OF TROY	12-26-18			X
Address (street, city, zip): 346 S GLOVER ROAD, RIVER FALLS, WI 54022					
<i>[Signature]</i> DALE VAN NURDEN	TOWN OF TROY	12-26-18			X
Address (street, city, zip): 326 S GLOVER ROAD, RIVER FALLS, WI 54022					
Signature:	Municipality:	DATE	Owner	Elector	Both
Address (street, city, zip):					
Signature:	Municipality:	DATE	Owner	Elector	Both
Address (street, city, zip):					
Signature:	Municipality:	DATE	Owner	Elector	Both
Address (street, city, zip):					
Signature:	Municipality:	DATE	Owner	Elector	Both
Address (street, city, zip):					
Signature:	Municipality:	DATE	Owner	Elector	Both
Address (street, city, zip):					
Signature:	Municipality:	DATE	Owner	Elector	Both
Address (street, city, zip):					
Signature:	Municipality:	DATE	Owner	Elector	Both
Address (street, city, zip):					
Signature:	Municipality:	DATE	Owner	Elector	Both
Address (street, city, zip):					
Signature:	Municipality:	DATE	Owner	Elector	Both
Address (street, city, zip):					
Signature:	Municipality:	DATE	Owner	Elector	Both
Address (street, city, zip):					
Signature:	Municipality:	DATE	Owner	Elector	Both
Address (street, city, zip):					

Make as many copies of this page as are needed. Attach all completed copies to the petition.





19-10

REC'D  
JAN - 9 2019  
WI DPI - SMS

Empire Builder Dr

alle

Southern Pacific Rd

Soo Line Rd

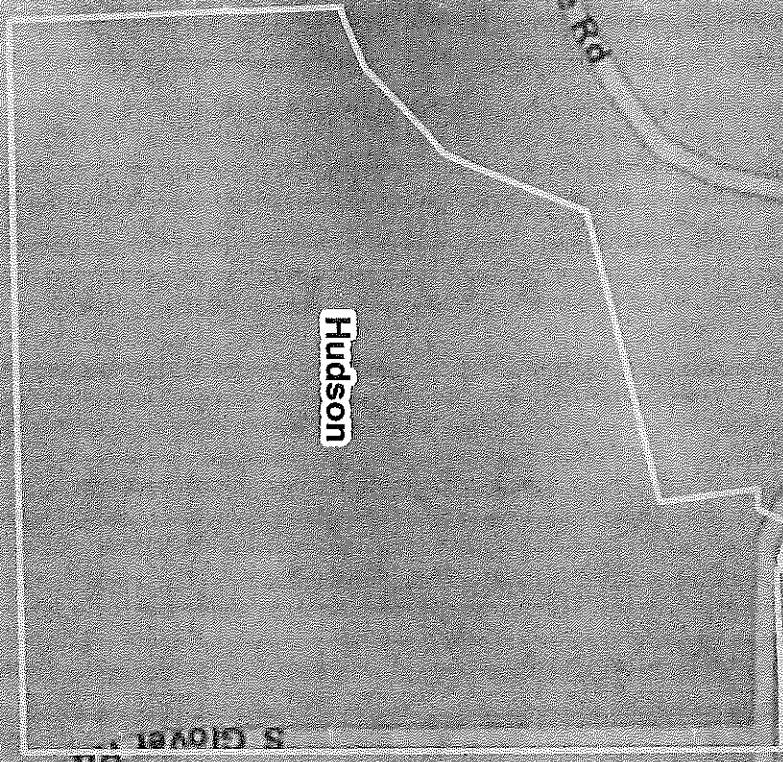

Hudson

N Gorsk Rd

Rubbia Ln

S Glover Rd

Glover

Sources: Esri, HERE, Garmin, USGS, Intermap, INCREMENT P, NRCan, Esri Japan, METI, Esri China (Hong Kong), Esri Korea, Esri (Thailand), NGCC, © OpenStreetMap contributors, and the GIS User Community



## REQUEST FOR REVIEW OR APPEAL SCHOOL DISTRICT BOUNDARY APPEAL BOARD (SDBAB)

- Provide complete contact information for the person or persons initiating this request for review.
- Submit the request to the Secretary of the School District Boundary Appeal Board (see address below) **BEFORE THE DEADLINE SHOWN ON THE COVER LETTER.**
- **Include a check or money order for the amount specified to cover the costs of convening the Board or Appeal Panel.** (Section 117.05(9) of the Wisconsin state statutes authorizes the state superintendent to charge a fee to reimburse the department for the costs of any review or appeal.)
- If there are multiple individuals requesting this review, page 2 may be used for the additional names and signatures (make sure the entire page gets copied).
- For more information go [http://sms.dpi.wi.gov/sms\\_rghearng](http://sms.dpi.wi.gov/sms_rghearng) on the Internet or contact Janice Zmrazek, 608/266-2803, [Janice.zmrazek@dpi.wi.gov](mailto:Janice.zmrazek@dpi.wi.gov).

INFORMATION PROVIDED BY THE REQUESTER (please print or type)			
Name(s): <i>Ryan Van Nurden Heidi Van Nurden</i>			
Mailing Address (street, city, zip): <i>346 S Glover Rd, River Falls, WI 54022</i>			
Phone Number	<i>612-282-8524</i>	E-mail Address	<i>Ryanmetro@aol.com</i>
In which School District is the property located?	<i>Hudson</i>		
What is the File # for the Petition?	<i>19-10</i>		

I/we, the undersigned, file this petition for review or notice of appeal for the file or order identified above.

(Use page 2 for additional signatures if there are multiple requesters)	(For each signature check one)			
SIGNATURE(S) of requester identified above	DATE	Property Owner	Elector	Both Owner and Elector
1. <i>[Signature]</i>	<i>3-8-19</i>			<input checked="" type="checkbox"/>
2. <i>[Signature]</i>	<i>3-8-19</i>			<input checked="" type="checkbox"/>

Pursuant to the provisions of Chapter 117, Wisconsin statutes, the signers of this request represent (check only one):

- A majority of the electors residing in the territory proposed for detachment
- The owners of 50 percent or more of the territory proposed for detachment

Mail the required filing fee, along with this request, to:	Secretary, School District Boundary Appeal Board Department of Public Instruction PO Box 7841 Madison, WI 53707-7841
--	---

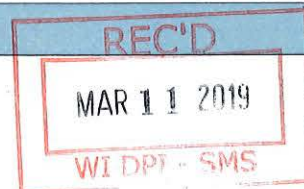

## REQUEST FOR REVIEW OR APPEAL SCHOOL DISTRICT BOUNDARY APPEAL BOARD (SDBAB) Form for signatures of additional requesters

**Instructions:** Each additional requester must sign the form, indicate a street address (not a PO box), and identify the municipality (the township, village, or city) where he/she resides. Indicate the date the form is signed. Each petitioner must also identify whether he/she is an owner of the territory proposed for detachment, an elector residing on the territory, or both an owner and resident elector.

I/we, the undersigned request a review of petition or order number <u>19-10</u> .			
			(For each signature check one)
Signature: <u>Dale VanNuden</u>	Municipality: <u>Town of Troy</u>	DATE	Owner    Elector    Both
Address (street, city, zip): <u>326 S Glover Rd, River Falls, WI 54022</u>		<u>3-8-19</u>	<input type="checkbox"/> <input type="checkbox"/> <input checked="" type="checkbox"/>
Signature:	Municipality:	DATE	Owner    Elector    Both
Address (street, city, zip):			
Signature:	Municipality:	DATE	Owner    Elector    Both
Address (street, city, zip):			
Signature:	Municipality:	DATE	Owner    Elector    Both
Address (street, city, zip):			
Signature:	Municipality:	DATE	Owner    Elector    Both
Address (street, city, zip):			
Signature:	Municipality:	DATE	Owner    Elector    Both
Address (street, city, zip):			
Signature:	Municipality:	DATE	Owner    Elector    Both
Address (street, city, zip):			
Signature:	Municipality:	DATE	Owner    Elector    Both
Address (street, city, zip):			
Signature:	Municipality:	DATE	Owner    Elector    Both
Address (street, city, zip):			
Signature:	Municipality:	DATE	Owner    Elector    Both
Address (street, city, zip):			
Signature:	Municipality:	DATE	Owner    Elector    Both
Address (street, city, zip):			
Signature:	Municipality:	DATE	Owner    Elector    Both
Address (street, city, zip):			
Signature:	Municipality:	DATE	Owner    Elector    Both
Address (street, city, zip):			
Signature:	Municipality:	DATE	Owner    Elector    Both
Address (street, city, zip):			

Make as many copies of this page as are needed. Ensure the entire page gets copied if multiple pages are needed.  
Attach all completed copies to the request for review.

**MATERIALS  
FROM  
DETACHING  
DISTRICT**



**SCHOOL BOARD RESOLUTION  
AUTHORIZING ISSUANCE OF AN ORDER**

**WHEREAS**, a meeting of the school board of the School District of Hudson was held on February 11, 2019, and

**WHEREAS**, a petition has been filed with the clerk of the school board, pursuant to s. 117.11-13, Wis Stats., proposing the detachment of Parcel #040-1066-60-001 SEC 16 T28N R19W NE SE BEING CSM 27-6158 LOT 1 and Parcel #040-1066-60-002 SEC 16 T28N R19W PART OF NEW SE AND SE SE BEING CSM 27-6158 LOT 2 from the Hudson School District.

**WHEREAS**, a public hearing has been held on the proposed reorganization by the school board pursuant to s. 117.11-13, Wis Stats.,

**NOW, THEREFORE, BE IT RESOLVED** that an order be issued and filed denying the petition upon which said hearing has been held.

**Introduced by:** Sue Kattas

**Seconded by:** Bruce Hanson

**Vote:** Yes 6 No 0

Dated this 11th day of February 2019

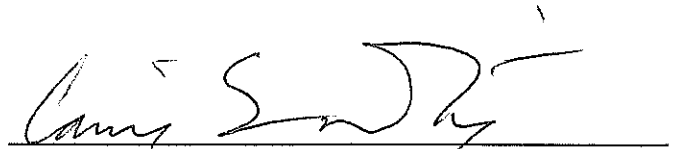

Carrie Whitacre  
Clerk School District of Hudson





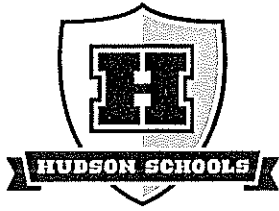

**Board of Education**  
**Meeting Announcement**  
6:00 p.m. Monday, February 11, 2019  
Administrative Service Center  
644 Brakke Drive, Hudson, WI 54016

## AGENDA

- 1) Call to Order & Pledge of Allegiance
- 2) Recognition
  - a) Perfect Scores on ACT Exam
- 3) Citizens Request to Speak about Non-Action Items
- 4) Superintendent's Reports
  - a) Scorecards Update
  - b) Plan for make up of missed days
- 5) Reports
  - a) Butterfly Path-Mental Health Donation
  - b) Middle School English Language Arts (ELA) Update
  - c) Transportation Update
  - d) Second Friday of January Enrollment Report
  - e) Transition Plan Related to Boundary Reset
- 6) Topics for Discussion and/or Possible Action
  - a) Consent Items
    - i) Approval of the January 14, 2019 Board Meeting Minutes, January 28, 2019, Special Meeting Minutes
    - ii) Personnel Hires, Changes, Retirements/Resignations/Non-Renewals/Terminations and Leaves
    - iii) Expenditures
  - b) Petition from the Van Nurden family to transfer property from the Hudson School District to the River Falls School District
  - c) Approve weather make up plan
- 7) The Board will consider a motion to convene to closed session pursuant to Wisconsin Statute 19.85(1)(f) to consider social or personal histories of such persons which if discussed in public, would be likely to have a substantial adverse effect upon the reputation of any person referred to in such histories or data.
- 8) Adjourn



Hudson School District  
Regular Board of Education Meeting  
February 11, 2019

Open Session

1. The regular meeting of the Hudson Board of Education was called to order by Board President Jamie Johnson at approximately 6:00 p.m. in the first-floor meeting room of the Administrative Service Center, 644 Brakke Drive, Hudson, WI. Members present Bob Baumann, Bruce Hanson, James Johnson, Sue Kattas, Heather Logelin, and Carrie Whitacre (joined at 6:08 p.m.). Administrators in attendance included Superintendent Nick Ouellette, Assistant Superintendent Dave Grambow, Chief Financial, and Operations Officer Tim Erickson, Chief of Human Resources Officer Andrea Voelker, Chief of Schools Officer Erin Schiltgen, Director of Teaching and Learning Sandra Kovatch.
2. Director of Teaching and Learning Sandra Kovatch congratulated Hudson High School Juniors Amanda Ichel and Alex Weaver for achieving a perfect score on the ACT test. Only one-tenth of one percent of all students taking the ACT test achieve a perfect score of 36.
3. Four citizens spoke to the Board of Education regarding the Hudson Middle School pool. Alex and Karrie Weaver and Paul and Laurie Stein.
4. Superintendent Ouellette provided an update on the District Scorecards. With five areas of measurement, 1-Strong academic achievement, 2-Prepare students for post-graduate success with life skills, 3-Supportive and inclusive learning environment, 4-Recruiting, retaining and supporting quality employees, and 5-Parents and community are engaged and know what's going on. Building level scorecards will be developed and shared at a future Board meeting.
5. Superintendent Ouellette outlined a plan to make up the instructional days missed due to inclement weather. The Board will take action on a recommended plan later in the meeting.
6. Chief of Schools Officer Erin Schiltgen introduced Anna Johnson, founder of The Butterfly Path, a locally based organization raising funds to support mental health education. The Butterfly Path donation will support co-located mental health programs in the District.
7. Sandra Kovatch introduced Middle School Instructional Coach MaryBeth Elliott, who reviewed the English Language Arts curriculum in grades 6-8.
8. Chief of Human Resources Officer Andrea Voelker introduced Steve Schoenecker the Assistant Director of Transportation. Schoenecker demonstrated the new tablet technology that will be on buses, allowing students and drivers to monitor who is riding each bus. He also discussed the Traversa software that will allow the District to know the location of each bus during their routes.

9. Chief Financial and Operations Officer Tim Erickson reviewed the second Friday of January enrollment numbers, as reported to the Department of Public Instruction. The Hudson School District was up six students for a total of 5,682 students in grades 4K through 12.
10. Assistant Superintendent Dave Grambow, Chief of Human Resources Officer Andrea Voelker, and Chief of Schools Officer Erin Schiltgen reviewed plans related to transitioning students to new elementary schools due to the elementary boundary changes. Multiple events and forms of communication will allow students opportunities to learn about their new schools.
11. Hanson moved, with second by Baumann, to approve the consent items which include approval of the January 14, 2019, regular Board meeting minutes, the January 28, 2019, special Board meeting minutes, the personnel hires, changes, retirements, resignations, non-renewals, terminations, and leaves (attached), Expenditures in the amount of \$2,160,542.98, Receipts totaling \$9,255,084.77, Payroll totaling \$2,209,991.33 and EFT/ACH payments totaling \$1,416,233.34. The motion carried.
12. Chief of Human Resources Officer Andrea Voelker recognized the retirement of High School Associate Principal Wendy Langer and teachers David Hammond, Therese Swinney, Kathy Heth, Patricia Steely, Jonathan Hilding, and Susan Randall. All retirees will be recognized at the staff recognition banquet on Monday, April 29th.
13. Kattas moved, with second by Hanson, to deny the Van Nurden petition to transfer property from the Hudson School District to the River Falls School District. The motion carried.
14. Hanson moved, with second by Logelin to approve the inclement weather make-up plan. The motion carried.
15. At 7:55 p.m. Hanson moved, with second by Kattas to convene to closed session pursuant to Wisconsin Statute 19.85(1)(f) to consider social or personal histories of such persons which if discussed in public, would be likely to have a substantial adverse effect upon the reputation of any person referred to in such histories or data. On a roll call vote the clerk recorded the following; Baumann-aye, Hanson-aye, Kattas-aye, Logelin-aye, Whitacre-aye, Johnson-aye. The motion carried.

---

James Johnson  
President

Example form provided by DPI

# PETITION TO ALTER SCHOOL DISTRICT BOUNDARIES

Detachment and Attachment of Small Territory - see section 117.12, Wisconsin Statutes

The petitioner should complete Section 1, take the form to the municipal clerk to complete Section 2, and then submit the petition to the school district where the property is located. See [http://sms.dpi.wi.gov/sms\\_rgsmllo](http://sms.dpi.wi.gov/sms_rgsmllo) on the Internet for more information. The petition must be submitted to the school district **BEFORE FEBRUARY 1**.

## SECTION 1 - TO BE COMPLETED BY THE PERSON SUBMITTING THE PETITION (please print or type)

Petitioner Name(s) RYAN VAN NURDEN AND HEIDI VAN NURDEN

Address (street, city, zip) 346 S GLOVER ROAD, RIVER FALLS, WI 54022

Phone Number 612-282-8524 E-mail RYANMETRO@AOL.COM

Legal Description of Territory Proposed for Detachment INCLUDING PARCEL NUMBERS: \_\_\_\_\_

PARCEL # 040-1066-60-001 SEC 16 T28N R19W NE SE BEING CSM 27-6158 LOT 1

PARCEL # 040-1066-60-002 SEC 16 T28N R19W PART OF NE SE AND NW SE BEING CSM 27-6158 LOT 2

(If more space is needed to describe the property, attach additional pages)

I/we, the undersigned, representing 50% of the owners or a majority of electors owning or residing on the above described territory, file this petition to detach the above described territory FROM the HUDSON School District and to attach it TO the RIVER FALLS School District.

SIGNATURE(S)	DATE	(For each signature check one)		
		Property Owner	Elector	Both Owner and Elector
1. <i>[Signature]</i>	12-26-18			X
2. <i>[Signature]</i>	12-26-18			X

## SECTION 2 - TO BE COMPLETED BY THE CLERK OF THE MUNICIPALITY IN WHICH THE TERRITORY IS LOCATED - (please print or type)

The legal description of the territory proposed for detachment is sufficient to identify its location and value. YES  NO   
(If no, return the form to the petitioner.)

School District where territory is located	<u>River Falls Hudson</u>	Value of Property	<u>6666.900<sup>00</sup></u>
Municipality where territory is located	<u>Town of Troy</u>	Year Value was Determined	<u>2018</u>
County where territory is located	<u>St. Croix</u>	Assessment Ratio	<u>.9089</u>

I, the undersigned, certify that the property description in Section 1 is sufficient to determine its location and value and that the information entered above in Section 2 is correct.

SIGNATURE OF MUNICIPAL CLERK Jennifer Clark Date: 12/27/2018

Name of Clerk (please print) Jennifer Clark

Mailing Address 651 Glover Road

Phone Number 715-425-2665 E-mail Address townofroy@baldwin-tek.com.net

## SECTION 3 - TO BE COMPLETED BY THE CLERK OF THE SCHOOL DISTRICT IN WHICH THE TERRITORY IS LOCATED - (please print or type)

District receiving petition School District of Hudson Date received 12/27/2018

Number of pupils residing in the territory described in Section 1 who were enrolled in the district as of the most recent 3<sup>rd</sup> Friday in September or 2<sup>nd</sup> Friday in January (see s.121.05 (1) (a), Wisconsin statutes). 0

Name of School District Clerk (please print) Carrie Whitacre Phone 715-377-3702

SIGNATURE OF SCHOOL DISTRICT CLERK Carrie Whitacre

After completing Section 3 the clerk of the detaching school district must send a certified copy (a document with original signatures or a photocopy accompanied by a Certificate of True Copy) of this petition to the school board of the school district to which the property is proposed to be attached and also to :

Secretary, School District Boundary Appeal Board  
Department of Public Instruction  
PO Box 7841  
Madison, WI 53707-7841

(For more information contact Janice Zurazek, 608/266-2803, [Janice.zurazek@dpi.wi.gov](mailto:Janice.zurazek@dpi.wi.gov). Both districts must act on this petition by March 1.)

Example form provided by DPI

## PETITION TO ALTER SCHOOL DISTRICT BOUNDARIES

Detachment and Attachment of Small Territory - see section 117.12, Wisconsin Statutes

### Signatures of additional petitioners

**Instructions:** Each additional petitioner must sign the form, indicate a street address (not a PO box), and identify the municipality (the township, village, or city) where he/she resides. Indicate the date the form is signed. Each petitioner must also identify whether he/she is an owner of the territory proposed for detachment, an elector residing on the territory, or both an owner and resident elector.

I/we, the undersigned, representing 50% of the owners or a majority of electors owning or residing on the territory described on the petition form, file this petition to detach the described territory FROM the HUDSON School District and to attach it TO the RIVER FALLS School District.

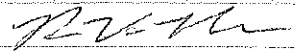
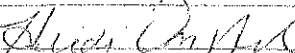
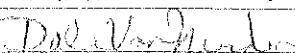
			DATE	(For each signature check one)		
Signature:		Municipality:		Owner	Elector	Both
	RYAN VAN NURDEN	TOWN OF TROY				
Address (street, city, zip): 346 S GLOVER ROAD, RIVER FALLS, WI 54022			12-26-18			X
	HEIDI VAN NURDEN	TOWN OF TROY				
Address (street, city, zip): 346 S GLOVER ROAD, RIVER FALLS, WI 54022			12-26-18			X
	DALE VAN NURDEN	TOWN OF TROY				
Address (street, city, zip): 326 S GLOVER ROAD, RIVER FALLS, WI 54022			12-26-18			X
Signature:		Municipality:	DATE	Owner	Elector	Both
Address (street, city, zip):						
Signature:		Municipality:	DATE	Owner	Elector	Both
Address (street, city, zip):						
Signature:		Municipality:	DATE	Owner	Elector	Both
Address (street, city, zip):						
Signature:		Municipality:	DATE	Owner	Elector	Both
Address (street, city, zip):						
Signature:		Municipality:	DATE	Owner	Elector	Both
Address (street, city, zip):						
Signature:		Municipality:	DATE	Owner	Elector	Both
Address (street, city, zip):						
Signature:		Municipality:	DATE	Owner	Elector	Both
Address (street, city, zip):						
Signature:		Municipality:	DATE	Owner	Elector	Both
Address (street, city, zip):						
Signature:		Municipality:	DATE	Owner	Elector	Both
Address (street, city, zip):						

Make as many copies of this page as are needed. Attach all completed copies to the petition.

Alt. Parcel #: 16.28.19.252A-1

TOWN OF TROY  
ST. CROIX COUNTY,  
WISCONSIN

<b>Owner and Mailing Address:</b> RYAN & HEIDI VAN NURDEN 346 S GLOVER RD RIVER FALLS WI 54022		<b>Co-Owner(s):</b>	
<b>Districts:</b>		<b>Physical Property Address(es):</b> * 346 S GLOVER RD	
<b>Dist#</b>	<b>Description</b>	<b>Parcel History:</b>	
2611	SCH DIST OF HUDSON	<b>Date</b>	<b>Doc #</b>
1700	WITC	07/20/2016	1032572
		10/02/2015	1019359
		10/17/2013	987670
		03/24/1986	410221
			more...
<b>Legal Description:</b> SEC 16 T28N R19W NE SE BEING CSM 27-6158 LOT 1		<b>Vol/Page</b>	<b>Type</b>
<b>Acres: 5.878</b>		/	WD
		27/6158	CSM
		/	WD
		735/86	WD

<b>Plat</b>	<b>Tract (S-T-R 40¼ 160¼ GL)</b>	<b>Block/Condo Bldg</b>
* 6158-CSM 27-6158 040-2015	16-28N-19W NE SE	LOT 1

**2018 Valuations:** Values Last Changed on 07/16/2018

Class and Description	Acres	Land	Improvement	Total
G1-RESIDENTIAL	5.878	79,400.00	498,100.00	577,500.00
<b>Totals for 2018</b>				
General Property	5.878	79,400.00	498,100.00	577,500.00
Woodland	0.000	0.00	0.00	0.00
<b>Totals for 2017</b>				
General Property	5.878	79,400.00	208,400.00	287,800.00
Woodland	0.000	0.00	0.00	0.00

<b>2018 Taxes</b>	<b>Bill #</b>	<b>Fair Market Value:</b>	<b>Assessment Ratio:</b>
	16295	635,400.00	0.9089

	Amt Due	Amt Paid	Balance	<b>Installments</b>	
				End Date	Total
Net Tax	8,814.61	4,317.93	4,496.68	1	01/31/2019
Special Assessments	0.00	0.00	0.00	2	07/31/2019
Special Charges	0.00	0.00	0.00		4,317.93
Delinquent Charges	0.00	0.00	0.00		4,496.68
Private Forest Crop	0.00	0.00	0.00	<b>Net Mill Rate</b> 0.015700371	
Woodland Tax	0.00	0.00	0.00	<b>Gross Tax</b> 10,102.31	
Managed Forest Land	0.00	0.00	0.00	<b>School Credit</b> 1,035.35	
Prop Tax Interest		0.00	0.00	<b>Total</b> 9,066.96	
Spec Tax Interest		0.00	0.00	<b>First Dollar Credit</b> 73.60	
Prop Tax Penalty		0.00	0.00	<b>Lottery Credit</b> 1 Claims 178.75	
Spec Tax Penalty		0.00	0.00	<b>Net Tax</b> 8,814.61	
Other Charges	0.00	0.00	0.00		
<b>TOTAL</b>	<b>8,814.61</b>	<b>4,317.93</b>	<b>4,496.68</b>		

Interest Calculated For 04/02/2019

(Posted  
Payment Payments)

Date	Receipt #	Type	Amount	Note
01/30/2019	474	T	4,317.93	Online web payment

Key

Payment Type: A - Adjustment, R - Redemption, T - Tax

\* -  
Primary





Alt. Parcel #: 16.28.19.252A-2

TOWN OF TROY  
ST. CROIX COUNTY,  
WISCONSIN

<b>Owner and Mailing Address:</b> DALE VANNURDAN 326 S GLOVER RD RIVER FALLS WI 54022		<b>Co-Owner(s):</b>	
<b>Districts:</b>		<b>Physical Property Address(es):</b> * 326 S GLOVER RD	
<b>Dist#</b>	<b>Description</b>	<b>Parcel History:</b>	
2611	SCH DIST OF HUDSON	<b>Date</b>	<b>Doc #</b>
1700	WITC	10/02/2015	1019359
		10/17/2013	987670
		03/24/1986	410221
		<b>Vol/Page</b>	<b>Type</b>
		27/6158	CSM
		/	WD
		735/86	WD
<b>Legal Description:</b> SEC 16 T28N R19W PART OF NE SE AND NW SE BEING CSM 27-6158 LOT 2		<b>Acres:</b> 27.088	

<b>Plat</b>	<b>Tract (S-T-R 40% 160% GL)</b>	<b>Block/Condo Bldg</b>
* 6158-CSM 27-6158 040-2015	16-28N-19W NE SE	LOT 2
N/A-NOT AVAILABLE	16-28N-19W	

**2018 Valuations:** Values Last Changed on 09/01/2016

Class and Description	Acres	Land	Improvement	Total
G2-COMMERCIAL	0.960	43,200.00	33,700.00	76,900.00
G4-AGRICULTURAL	24.128	5,500.00	0.00	5,500.00
G5-UNDEVELOPED	2.000	7,000.00	0.00	7,000.00
<b>Totals for 2018</b>				
General Property	27.088	55,700.00	33,700.00	89,400.00
Woodland	0.000	0.00	0.00	0.00
<b>Totals for 2017</b>				
General Property	27.088	55,700.00	33,700.00	89,400.00
Woodland	0.000	0.00	0.00	0.00

<b>2018 Taxes</b>	<b>Bill #</b> 16296	<b>Fair Market Value:</b> Use Value Assessment	<b>Assessment Ratio:</b> 0.9089
-------------------	------------------------	---	------------------------------------

	Amt Due	Amt Paid	Balance	<b>Installments</b>	
Net Tax	1,330.01	1,330.01	0.00	<b>End Date</b>	<b>Total</b>
Special Assessments	0.00	0.00	0.00	1 01/31/2019	665.01
Special Charges	0.00	0.00	0.00	2 07/31/2019	665.00
Delinquent Charges	0.00	0.00	0.00	<b>Net Mill Rate</b> 0.015700371	
Private Forest Crop	0.00	0.00	0.00	<b>Gross Tax</b> 1,563.89	
Woodland Tax	0.00	0.00	0.00	<b>School Credit</b> 160.28	
Managed Forest Land	0.00	0.00	0.00	<b>Total</b> 1,403.61	
Prop Tax Interest		0.00	0.00	<b>First Dollar Credit</b> 73.60	
Spec Tax Interest		0.00	0.00	<b>Lottery Credit</b> 0 Claims 0.00	
Prop Tax Penalty		0.00	0.00	<b>Net Tax</b> 1,330.01	
Spec Tax Penalty		0.00	0.00		
Other Charges	0.00	0.00	0.00		
<b>TOTAL</b>	<b>1,330.01</b>	<b>1,330.01</b>	<b>0.00</b>		

Interest Calculated For 04/02/2019

(Posted  
Payments)

Date	Receipt #	Type	Amount	Note
02/05/2019	38304	T	1,330.01	NURDEN CK# 2874 DA



**Hudson School District  
Office of the Superintendent**

644 Brakke Dr., Hudson, WI 54016  
715.377.3702

April 19, 2019

Secretary  
School District Boundary Appeal Board  
Department of Public Instruction  
P.O. Box 7841  
Madison, WI 53707-7841

Dear Secretary,

On behalf of the Hudson School District please accept the following information with regard to File # 19-10, a Request for Review or Appeal to the School District Boundary Appeal Board regarding property owned by Ryan and Heidi Van Nurden, and Dale Van Nurden.

- We believe the property in question should remain in the Hudson School District to avoid any reduction in the total valuation of the District, and the undue financial impact the loss would have on the remaining property owners.

Please contact us should you have any questions regarding this matter.

Sincerely,



Nick Ouellette  
Superintendent

NO/tm  
Enclosures



Hudson Middle School TEACHER SCHEDULES 2018-19

Grade 6

	Rm #	Advisory 7:42-8:03	Hour 1 8:06-8:51	Hour 2 8:54-9:39	Hour 3 9:42-10:27	Lunch A 10:27-10:57	Hour 4 11:00-11:45	Hour 5 11:48-12:33	Hour 6 12:36-1:21	Hour 7 1:24-2:09	Hour 8 2:12-2:57
<b>EXCALIBUR</b>											
BALUSEK, MARTA	179	Advisory 6	Team Prep	Science	Science	Lunch	Science	Science	Prep	Science	PAT
HACKBARTH-MILLER, KELLY	176	Advisory 6	Team Prep	i3 LA	i3 LA	Lunch	i3 LA	Prep	i3 LA	i3 LA	PAT
LARSEN, NEDA	178	Advisory 6	Team Prep	Language Arts	Language Arts	Lunch	Language Arts	Prep	Language Arts	Language Arts	PAT
PAUL, RYAN	175	Advisory 6	Team Prep	Social Studies	Social Studies	Lunch	Social Studies	Social Studies	Social Studies	Prep	PAT
STEELY, PATTI	177	Advisory 6	Team Prep	Math 6+	Math 6	Lunch	Math 6	Math 6	Prep	Math 6	PAT

<b>MERLIN</b>											
HOFBAUER, RYAH	156	Advisory 6	Prep	Science	Science	Lunch	Science	Language Arts	Team Prep	PAT	
GARRARD, COURTNEY	158	Advisory 6	Math 6+	Prep	Math 6	Lunch	Math 6	Language Arts	Team Prep	PAT	
LINDBERG, CHARMAINE	157	Advisory 6	Social Studies	Social Studies	Prep	Lunch	Social Studies	Language Arts	Team Prep	PAT	

<b>RAIDER BLUE</b>											
LUEDTKE, MAREN	167	Advisory 6	Math 6+	Math 6+	Team Prep	Lunch	Math 6	Math 6	Prep	Math 6	PAT
KOWALCHYK, WADE	165	Advisory 6	Science	Science	Team Prep	Lunch	Science	Science	Prep	Science	PAT
MILLER, KAYLA	168	Advisory 6	Social Studies	Social Studies	Team Prep	Lunch	Social Studies	Social Studies	Social Studies	Prep	PAT
SWANSON, DEANNE	169	Advisory 6	Language Arts	Language Arts	Team Prep	Lunch	Language Arts	Prep	Language Arts	Language Arts	PAT
WERT, BROOKE	166	Advisory 6	i3 LA	i3 LA	Team Prep	Lunch	i3 LA	Prep	i3 LA	i3 LA	PAT

<b>RAIDER WHITE</b>											
AUSTIN, RHONDA	138	Advisory 6	i3 LA	Team Prep	i3 LA	Lunch	i3 LA	Prep	i3 LA	i3 LA	PAT
BAILLARGEON, DREW	136	Advisory 6	Social Studies	Team Prep	Social Studies	Lunch	Social Studies	Social Studies	Social Studies	Prep	PAT
GUNDERSON, NICOLE	137	Advisory 6	Language Arts	Team Prep	Language Arts	Lunch	Language Arts	Prep	Language Arts	Language Arts	PAT
JUNESKI, AMANDA	135	Advisory 6	Math 6	Team Prep	Math 6	Lunch	Math 6	Math 6	Prep	Math 6+	PAT
WICKSTROM, ERIC	139	Advisory 6	Science	Team Prep	Science	Lunch	Science	Science	Prep	Science	PAT

Hudson Middle School TEACHER SCHEDULES 2018-19

Grade 7

	Rm #	Advisory 7:42-8:03	Hour 1 8:06-8:51	Hour 2 8:54-9:39	Hour 3 9:42-10:27	Hour 4 10:30-11:15	Lunch 11:15-11:45	Hour 5 11:48-12:33	Hour 6 12:36-1:21	Hour 7 1:24-2:09	Hour 8 2:12-2:57
<b>AVALON</b>											
CAMPBELL, ROSS	267	Advisory 7	Language Arts	Language Arts	Team Prep	Language Arts	Lunch	Prep	Language Arts	PAT	Language Arts
HALSTEAD, KARI	269	Advisory 7	i3 LA	i3 LA	Team Prep	i3 LA	Lunch	Prep	i3 LA	PAT	i3 LA
HEERDT, STEPHANIE	265	Advisory 7	Science	Science	Team Prep	Science	Lunch	Science	Prep	PAT	Science
MAJERUS, MARK	266	Advisory 7	Math 7	Math 7	Team Prep	Math 7	Lunch	Math 7	Prep	PAT	Pre Algebra
YELL, MIKE	268	Advisory 7	Social Studies	Social Studies	Team Prep	Social Studies	Lunch	Social Studies	Social Studies	PAT	Prep

<b>CAMELOT</b>											
CHUKEL, TIM	238	Advisory 7	Math 7	Team Prep	Pre Algebra	Pre Algebra	Lunch	Math 7	Prep	PAT	Math 7
KNOBLE, LUKE	236	Advisory 7	Social Studies	Team Prep	Social Studies	Social Studies	Lunch	Social Studies	Social Studies	PAT	Prep
MEINCKE, TONY	239	Advisory 7	Science	Team Prep	Science	Science	Lunch	Science	Prep	PAT	Science
REHMUS, ANGELA	237	Advisory 7	i3 LA	Team Prep	i3 LA	i3 LA	Lunch	Prep	i3 LA	PAT	i3 LA
STUBBENDICK, MAIJA	235	Advisory 7	Language Arts	Team Prep	Language Arts	Language Arts	Lunch	Prep	Language Arts	PAT	Language Arts

<b>HASTINGS</b>											
MATSON, ERICA	251	Advisory 7	Prep	Science	Science	Science	Lunch	Language Arts		PAT	Team Prep
SORENSEN, EMILY	252	Advisory 7	Pre Algebra	Prep	Math 7	Math 7	Lunch	Language Arts		PAT	Team Prep
SWANSON, CAT	253	Advisory 7	Social Studies	Social Studies	Prep	Social Studies	Lunch	Language Arts		PAT	Team Prep

<b>KNIGHTS</b>											
HOVLAND, LIZ	272	Advisory 7	Team Prep	Math 7	Math 7	Math 7	Lunch	Algebra	Prep	PAT	Algebra
MCCARTHY, KATIE	270	Advisory 7	Team Prep	Language Arts	Language Arts	Language Arts	Lunch	Prep	Language Arts	PAT	Language Arts
PAVLICHEK, KIM	273	Advisory 7	Team Prep	i3 LA	i3 LA	i3 LA	Lunch	Prep	i3 LA	PAT	i3 LA
SPILLMAN, CADY	271	Advisory 7	Team Prep	Social Studies	Social Studies	Social Studies	Lunch	Social Studies	Social Studies	PAT	Prep
VANDEN HEUVEL, ERIC	274	Advisory 7	Team Prep	Science	Science	Science	Lunch	Science	Prep	PAT	Science

Hudson Middle School TEACHER SCHEDULES 2018-19

Grade 8

	Rm #	Advisory 7:42-8:03	Hour 1 8:06-8:51	Hour 2 8:54-9:39	Hour 3 9:42-10:27	Hour 4 10:30-11:15	Hour 5 11:18-12:03	Lunch 12:03-12:33	Hour 6 12:36-1:21	Hour 7 1:24-2:09	Hour 8 2:12-2:57
<b>NOBLES</b>											
ANDERSON, MATT	128	Advisory 8	Team Prep	Prep	Science	Science	Science	Lunch	PAT	Science	Science
BENDLIN, TONI	130	Advisory 8	Team Prep	Language Arts	Language Arts	Language Arts	Prep	Lunch	PAT	Language Arts	Language Arts
GROSSENBACHER, BRYON	129	Advisory 8	Team Prep	Social Studies	Social Studies	Social Studies	Social Studies	Lunch	PAT	Social Studies	Prep
MITCHELL, KATIE	131	Advisory 8	Team Prep	Algebra	Algebra	Math 8	Math 8	Lunch	PAT	Prep	Math 8

<b>NORMAN</b>											
BJERK, KRISTY	123	Advisory 8	Language Arts	Language Arts	Team Prep	Language Arts	Prep	Lunch	PAT	Language Arts	Language Arts
CONKLIN, GWEN	121	Advisory 8	Prep	Science	Team Prep	Science	Science	Lunch	PAT	Science	Science
FOSSE, MATT	122	Advisory 8	Social Studies	Social Studies	Team Prep	Social Studies	Social Studies	Lunch	PAT	Social Studies	Prep
JOHNSON, MICHELE	120	Advisory 8	Math 8	Math 8	Team Prep	Math 8	Algebra	Lunch	PAT	Prep	Math 8

<b>LANCASTER</b>											
BLEGEN, BRENT	221	Advisory 8	Business	Math 8	Geometry	Geometry	Team Prep	Lunch	PAT	Prep	Business
CUMMINGS, MANDY	220	Advisory 8	Prep	Science	Reading Int.	Language Arts	Team Prep	Lunch	PAT	Science	Science
HAMMER, ASHLEY	222	Advisory 8	Language Arts	Social Studies	Social Studies	Social Studies	Team Prep	Lunch	PAT	Language Arts	Prep

<b>WINDSOR</b>											
BELISLE, GARRET	227	Advisory 8	Prep	Team Prep	Science	Science	Science	Lunch	PAT	Science	Science
DAHL, DAVE	228	Advisory 8	Math 8	Team Prep	Math 8	Math 8	Math 8	Lunch	PAT	Prep	Algebra
SLAIKEU, JESSICA	230	Advisory 8	Social Studies	Team Prep	Social Studies	Social Studies	Social Studies	Lunch	PAT	Social Studies	Prep
CLINT ST. JOHN	229	Advisory 8	Language Arts	Team Prep	Language Arts	Language Arts	Prep	Lunch	PAT	Language Arts	Language Arts

Hudson Middle School TEACHER SCHEDULES 2018-19

EXPLORATORY	Advisory 7:42-8:03	Hour 1 8:06-8:51	Hour 2 8:54-9:39	Hour 3 9:42-10:27	Lunch A 10:27-10:57	Hour 4 11:00-11:45	Hour 5 11:48-12:33		Hour 6 12:36-1:21	Hour 7 1:24-2:09	Hour 8 2:12-2:57
					Hour 4 10:30-11:15		Lunch B	Hour 5 11:18-12:03			
BAKKEN, BETHANY		German 8 Rm 128	German 8 Rm 228	<b>HIGH SCHOOL</b>							
BAUSCHELT, KADY	Advisory 7	7 PE	7 PE	7 PE	Team Prep	Lunch	6 PE / Health Rm 178		6 PE/H Rm 179	6 PE/H Rm 175	Prep
BRAY, JODIE	Advisory 6	Eng 6	Eng 6	Bio Med	Team Prep	Lunch	Eng 7		Prep	Bio Med	Comp Sci 7
BROWN, KAYLYNN	Advisory 6	Lessons	Lessons	Prep	Lessons	Lunch	Team Prep		Band 8	Lessons	Band 6
DART, SIERRA	Advisory 8	8 Health Rm 121 / PE	Prep	8 Health Rm 120 / PE	Team Prep	Lunch	6 Health Rm 169 / PE		6 Health Rm 165 / PE	6 Health Rm 168 / PE	8 Health Rm 122 / PE
DELEON, CHRIS	Advisory 8	Space	Prep	Eng 6	Team Prep	Electronics		Lunch	Eng 7	Electronics	
		Electronics				Space				Space	
		Space				Electronics				Electronics	
ELLSTROM, SARA	Advisory 8	6	6	6	Team Prep	Lunch	7		7	Prep	7
ENGSTROM-YDE, SARAH	Advisory 8	<b>TBD</b>									
GANGNON, DEBORAH	Advisory 8	Food Sci/Snack	Food Sci/Snack	Food Sci/Snack	Team Prep	Food Sci/Snack		Lunch	Prep	Tech Sew Fashion	Tech Sew Fashion
						Food for Fitness				Food for Fitness	Food for Fitness
						ABC Childcare				ABC Childcare	ABC Childcare
GUNDERSEN, JACKIE			8 Health Rm 229 / PE	8 Health Rm 219 / PE	Team Prep		8 Health Rm 221 / PE		Lunch		
HARKER, AARON	Advisory 6	Computer Sci 6	Computer Sci 6	Computer Sci 6	Team Prep	Lunch	Computer Sci 7		Computer Sci 7	Computer Sci 8	Prep
HRYNIEWICKI, DONNA	Advisory 8	Lessons	Lessons	Prep	Lessons	Lunch	Team Prep		Band 8	Band 7	Lessons
JAMIESON, RYAN	Advisory 6	7 PE	7 PE	7 PE	Team Prep	Lunch	6PE / Health Rm 306		6PE / H Rm 306	6PE / H Rm 306	Prep
KING-HILDRETH, JULIE	Advisory 8	Drawing	Drawing	Drawing	Team Prep	Painting		Lunch	Prep	Painting	Painting
		Ceramics	Ceramics	Ceramics		Drawing				Drawing	Drawing
		Sculpture	Sculpture	Painting		Ceramics				Ceramics	Ceramics
KNIPFER, RACHEL	Advisory 8	Lessons	Lessons	Prep	Lessons	Lunch	Team Prep		Orchestra 8	Orchestra 7	Orchestra 6
KNOX, MIKE	Advisory 7	German 7	German 7	German 7	German 8	German 8		Lunch	Team Prep	German 8	Prep
KOWALCHYK, MISSY	Advisory 6	MVRC (7th Grade)	MVRC (6th Grade)	Read 180 (7th/8th Grade)	Lunch	Read 180		Prep	Push-In / Pull-Out	Team Prep (Merlin - Tuesday)	Intervention
LAM, JESSE	Advisory 7	Art 6	Art 6	Art 6	Team Prep	Lunch	Art 7		Art 7	Prep	Art 7
MAHER, ERIN	Advisory 6	Lessons	Lessons	Prep	Lessons	Lunch	Team Prep		Choir 8	Choir 7	Choir 6
MUELLER, AMY	Advisory 7	8 Health Rm 306	8 Health Rm 306	8 Health Rm 306	Team Prep	Lunch	7 Health Rm 267		7 Health Rm 266	Prep	7 Health Rm 268
NELSON, CELESTE	Advisory 7	Small Group Math	Small Group Math	Small Group Math	Small Group Math	Small Group Math		Lunch	Prep	Small Group Math	Prep
NGO, TOMMY	Advisory 8	Spanish 8	Spanish 8	Prep	Spanish 8	Spanish 8		Lunch	Team Prep	Spanish 8	Spanish 8
REVOIR, JIM	Advisory 6	Pathways 6	Pathways 6	Pathways 6	Prep	Lunch	Pathways 7		Pathways 7	Prep	Pathways 7
SCHARFENBERG, TIM	Advisory 6	7 PE	7 PE	7 PE	Team Prep	Lunch	6H Rm 306 / PE		6H Rm 306/ PE	6H Rm 306/ PE	Prep
STEIN, LEANN	Advisory 6	6	6	6	Lessons	Lunch	Team Prep		Lessons	Lessons	Prep



Hudson Middle School TEACHER SCHEDULES 2018-19

					Lunch A	Hour 4	Hour 5					
					10:27-10:57	11:00-11:45	11:48-12:33					
EXPLORATORY	Advisory 7:42-8:03	Hour 1 8:06-8:51	Hour 2 8:54-9:39	Hour 3 9:42-10:27	Hour 4 10:30-11:15		Hour 5 11:18-12:03	Lunch C	Hour 6 12:36-1:21	Hour 7 1:24-2:09	Hour 8 2:12-2:57	
STOLTE, LIZ	Advisory 8	Spanish 7	Spanish 7	Spanish 7	Spanish 8		Spanish 8	Lunch	Team Prep	Prep	Spanish 8	
STOSKOPF, MIKE	Advisory 8	8 PE	8 PE	Prep	Team Prep		Lunch	6 PE		6 PE	6 PE	PE
WEGNER, LIYA		Chinese 7 Rm 273	Chinese 7 Rm 236	Chinese 7 Rm 268	Prep		Chinese 8 Rm 222	HIGH SCHOOL				
WEILER, NICK	Advisory 8	8 PE / H Rm 130	Prep	8 PE	Team Prep		Lunch	6 Health		6 Health	6 Health	8 Health Rm 129

Hudson Middle School TEACHER SCHEDULES 2018-19

SPED	Advisory 7:42-8:03	Hour 1 8:06-8:51	Hour 2 8:54-9:39	Hour 3 9:42-10:27	Lunch A 10:27-10:57	Hour 4 11:00-11:45		Hour 5 11:48-12:33		Hour 6 12:36-1:21	Hour 7 1:24-2:09	Hour 8 2:12-2:57
					Hour 4 10:30-11:15		Hour 5 11:18-12:03		Lunch C			
ALTON, JODY	Advisory 8	Team Prep	Social Skills	Social Skills/PAT	Gen Ed Science Maison/USH Hammer/LA Cummings		Prep/8th Gr. Lunch Supervision		Lunch	8th Grade PAT	Social Skills	6th Grade PAT
EBBEN, KAREN	Advisory 8 Balusek	Gen Ed Exploratory 6	Gen Ed Science Balusek	Blomed Bray	Lunch	Gen Ed WS Paul		Gen Ed Math 6 Steely/7 Chukel		Health 6 Even / LA McCarthy Odd	Gen Ed LA Larsen	Exp 7 PAT 6th
KALSOW, ANNE	Advisory 7 C. Swanson	Chinese Even / LA Hammer Odd	Science Cummings / USH Hammer	Help Alton PAT 1:1 / Social	Gen Ed Math 8 Mitchell		Gen Ed German Knox		Lunch	PAT Alton	Gen Ed LA Hammer	Health Odd, Phy Ed Day 4, Exploratory 7 Days 2, 6
AMENT, LACY	Advisory 8	Trans Math Yellow	Gen Ed LA Bjerk	Team Prep	Modified LA		Modified LA		Lunch	PAT	Gen Ed Science Conklin	Prep
STEWART, KELLI	Advisory 8 Ament	Math 8 Gen Ed Johnson	Gen Ed LA Bjerk	Math 8 Gen Ed Dahl	Gen Ed LA (Bjerk)		Gen Ed Science Conklin		Lunch	PAT	Gen Ed US History Fosse	Gen Ed Science Conklin
BEAUPRE, KATIE	Advisory 6	Read 180	Read 180	Team Prep	Lunch	Modified LA		Prep		OG	Gen Ed LAi3 Wert	PAT
BAUMGARTNER, SONJA	Advisory 6 Beaupre	Gen Ed WS Miller	Gen Ed Science Kowalchyk	Gen Ed Exploratory	Support 6th Grade Lunch	Supporting Student Transition	Lunch	Gen Ed Science Kowalchyk		Gen Ed PE/Health Bauschelt	Math Level E	PAT/Choir
PANTZKE, STEPH	Advisory 6 Kowalchyk	Gen Ed LA Swanson	Gen Ed WS Miller	Gen Ed Exploratory	Lunch	Gen Ed LAi3 Wert		Gen Ed Math 6 Luedtke		Gen Ed LAi3 Wert	Gen Ed PE/Health Dart	PAT
FIJALKIEWICZ, MATTHEW	Advisory 7	Gen Ed LAi3 Rehmus	Team Prep	Mod. LA	Gen Ed LA Stubbendick		Lunch	Gen Ed Science Meincke		CMC F	PAT	Prep
GREEN, ETHAN	Advisory 7 Fij		Gen Ed WL 7	Gen Ed Science Meincke			Lunch	Gen Ed Exploratory		Gen Ed LAi3 Rehmus	PAT	Gen Ed Math 7 Chukel
GERDTS, GAIL	Advisory 6	Team Prep	Math	Prep	Gen Ed Science Anderson		Written Lang 8		Lunch	PAT	Reading	Reading
FERGUSON, TANYA		Gen Ed Exploratory	Math Gerdts	Gen Ed WS Spillman	Lunch	Gen Ed Science Balusek		Gen Ed Health/Health Scharfenberg/Bauschelt		PAT 8	Reading Gerdts	PAT
JOHNSON, ERIC	Advisory 8	Math Level E Room 154	Room 154 OR Windsor Office (Team Prep or SpEd Mtg on Tues)	Room 154 Social Skills	8100		Gen Ed Math Dahl		Lunch	Room 154 PAT	Room 154 PAT	Room 231 CMC F Peterson
HALVERSON, LORI	Advisory 8 Bellisle	Gen Ed US History Fosse	Gen Ed WL	Reading Scanlan	Modified LA Peterson		Lunch	11:45 support soft landing / Lunch Set	Support 8th Grade Lunch	Gen Ed LA McCarthy	Gen Ed Science Bellisle	Gerdts PAT
MORNING, LINDA	Advisory 6	Social Skills	Team Prep	Gen Ed LA Gunderson	Lunch	Gen Ed Math Juneski		Prep		Gen Ed LAi3 Austin	Level E	PAT
SCHULLO, TAMI	Advisory 6 Morning	Gen Ed LAi3 Austin	Gen Ed Exploratory	Gen Ed Science Wickstrom	Lunch	Gen Ed LA Gunderson		Gen Ed Science Wickstrom		Gen Ed WS Ballargeon	Gen Ed LAi3 Austin	PAT
PETERSON, SAM	Advisory 8	Gen Ed Math 8 Dahl	Team Prep	Gen Ed LA St. John	Modified LA		Prep		Lunch	PAT	Gen Ed US History Slaikeu	CMC Level F
DUHOUX, SHAWN	Advisory 8 Bellisle/King- Hildreth	Gen Ed LA St. John	Gen Ed PE/Health Gunderson	Gen Ed Science Bellisle	Days 2,3,5 Modified LA Peterson	Days 1,4,6 Lunch	Days 2,3,5 Gen Ed Math Dahl	Day 1 Gen Ed PE Jamieson	Day 4 & 6 Gen Ed PE Scharfenberg Lunch C on Days 2,3,5	PAT	Gen Ed Science Bellisle	Gen Ed Science Bellisle
SCANLAN, STEPH	Advisory 7	Team Prep	Math	Reading	Reading		Written Language		Lunch	Gen Ed WS Paul	PAT	Prep
JOHN, ABBY	Advisory 6 Steely	Ceramics King-Hildreth	Math Wetherbee	Gen Ed Math 7 Sorenson	Supporting 6th Grade Lunch	Supporting Student Transitions	Lunch	Gen Ed Science Balusek		PAT	Math Scanlan	Gen Ed Health (every day) Dart
ROBEY, RITA	Advisory 6 Paul	Gen Ed Exploratory 6	Math Scanlan	WL (2, 4, 6) Collaboration (1, 3, 5)	Lunch	Written Language Scanlan		Gen Ed Exploratory 7		Gen Ed WS Spillman	Gen Ed Science Balusek	Gen Ed Science Vanden Heuvel
Doris (Intervener-916)	Advisory 6 Balusek	Gen Ed Exploratory 6	Math Scanlan	Reading Scanlan	Supporting 6th Grade Lunch	Supporting Student Transitions	Lunch	Science (1, 3, 5, 6) Balusek Speech (2, 4)		Gen Ed WS Paul	Phy. Ed. (1) APE (3, 5) Swimming/Se nsory (2, 4, 6)	PAT (1, 3, 4, 5, 6) Scanlan APE (2)
SWINNEY, TERRI	Advisory 7	OG	Team Prep	Team Prep	OG		OG		Lunch	PAT	PAT	Hudson Prairie
TOLL, JEN	Advisory 8 Swinney	Gen Ed Math 7 Chukel	Gen Ed WL 7	Gen Ed US History Slaikeu	READ 180		Gen Ed Math Dahl		Lunch	PAT	Gen Ed LA St. John	Gen Ed LA St. John
WATTERS, KIRSTIN	Advisory 7	Trans Math Blue	Gen Ed LAi3 Halstead	Team Prep	CMC F		Lunch	Read 180		Read 180	PAT	Prep

Hudson Middle School TEACHER SCHEDULES 2018-19

NAGEL, LISA	Advisory 7 Walters	Gen Ed Science/WS Heerd/Yell	Gen Ed Math Majerus	Gen Ed WL	Gen Ed LAI3/Science Halstead/Heerd	Lunch	Gen Ed Science Heerd	Gen Ed WS Yell	PAT	Gen Ed LA/LAI3 Halstead/ Campbell
WETHERBEE, COURTNEY	Advisory 7 Co-Matson	Team Prep	Math Functional	Gen Ed LA Larsen	Writing	Lunch	Writing	Writing	Regulation /Reading	Prep
BEAVERS, BECKY	Advisory 8 Slotte	Gen Ed WS C. Swanson	Gen Ed LAI3 Hackbarth Miller	Gen Ed US History Grossenbacher	Gen Ed Science Matson	Gen Ed Science Anderson	Lunch	Gen Ed WS Paul	ABC Childcare Gangnon	PAT Excalibur Abby (Steeley) Ian (Paul)



Hudson School District Elementary Course Offerings 2018-19

Course	Short Description	Sec	Enrl T1	Enrl T2	Enrl T3	Teacher	Dsp Prd
1020	READING 1	1-1	20	20	20	KLIMEK, GINA	4
1020	READING 1	1-2	20	20	20	LILA, CHRIS	4
1020	READING 1	1-3	21	21	21	SCHUETT, BRIDGET	4
1020	READING 1	1-4	19	19	19	WARREN, JULIE	4
1022	LANGUAGE ARTS 1	1-1	20	20	20	KLIMEK, GINA	14
1022	LANGUAGE ARTS 1	1-2	20	20	20	LILA, CHRIS	14
1022	LANGUAGE ARTS 1	1-3	21	21	21	SCHUETT, BRIDGET	14
1022	LANGUAGE ARTS 1	1-4	19	19	19	WARREN, JULIE	14
1025	WRITING 1	1-1	20	20	20	KLIMEK, GINA	5
1025	WRITING 1	1-2	20	20	20	LILA, CHRIS	5
1025	WRITING 1	1-3	21	21	21	SCHUETT, BRIDGET	5
1025	WRITING 1	1-4	19	19	19	WARREN, JULIE	5
1030	MATH 1	1-1	20	20	20	KLIMEK, GINA	7
1030	MATH 1	1-2	20	20	20	LILA, CHRIS	7
1030	MATH 1	1-3	21	21	21	SCHUETT, BRIDGET	7
1030	MATH 1	1-4	19	19	19	WARREN, JULIE	7
1040	SCI/SS/HLTH 1	1-1	20	20	20	KLIMEK, GINA	8
1040	SCI/SS/HLTH 1	1-2	20	20	20	LILA, CHRIS	8
1040	SCI/SS/HLTH 1	1-3	21	21	21	SCHUETT, BRIDGET	8
1040	SCI/SS/HLTH 1	1-4	19	19	19	WARREN, JULIE	8
1ST	1ST GRADE	1-1	20	20	20	KLIMEK, GINA	1
1ST	1ST GRADE	1-2	20	20	20	LILA, CHRIS	1
1ST	1ST GRADE	1-3	21	21	21	SCHUETT, BRIDGET	1
1ST	1ST GRADE	1-4	19	19	19	WARREN, JULIE	1
2020	READING 2	2-1	22	22	22	CLAYCOMB, DIANE	4
2020	READING 2	2-2	21	21	21	KLEPP, BRIEANN	4
2020	READING 2	2-3	20	20	20	KREIBICH, JODY	4
2020	READING 2	2-4	18	18	18	WERT, ADAM B	4
2022	LANGUAGE ARTS 2	2-1	22	22	22	CLAYCOMB, DIANE	14
2022	LANGUAGE ARTS 2	2-2	21	21	21	KLEPP, BRIEANN	14
2022	LANGUAGE ARTS 2	2-3	20	20	20	KREIBICH, JODY	14
2022	LANGUAGE ARTS 2	2-4	18	18	18	WERT, ADAM B	14
2025	WRITING 2	2-1	22	22	22	CLAYCOMB, DIANE	5
2025	WRITING 2	2-2	21	21	21	KLEPP, BRIEANN	5
2025	WRITING 2	2-3	20	20	20	KREIBICH, JODY	5
2025	WRITING 2	2-4	18	18	18	WERT, ADAM B	5
2030	MATH 2	2-1	22	22	22	CLAYCOMB, DIANE	7
2030	MATH 2	2-2	21	21	21	KLEPP, BRIEANN	7
2030	MATH 2	2-3	20	20	20	KREIBICH, JODY	7

Hudson School District Elementary Course Offerings 2018-19

Course	Short Description	Sec	Enrl T1	Enrl T2	Enrl T3	Teacher	Dsp Prd
2030	MATH 2	2-4	18	18	18	WERT, ADAM B	7
2060	SCI/SS/HLTH 2	2-1	22	22	22	CLAYCOMB, DIANE	8
2060	SCI/SS/HLTH 2	2-2	21	21	21	KLEPP, BRIEANN	8
2060	SCI/SS/HLTH 2	2-3	20	20	20	KREIBICH, JODY	8
2060	SCI/SS/HLTH 2	2-4	18	18	18	WERT, ADAM B	8
2ND	2ND GRADE	2-1	22	22	22	CLAYCOMB, DIANE	1
2ND	2ND GRADE	2-2	21	21	21	KLEPP, BRIEANN	1
2ND	2ND GRADE	2-3	20	20	20	KREIBICH, JODY	1
2ND	2ND GRADE	2-4	18	18	18	WERT, ADAM B	1
3020	READING 3	3-1	21	21	21	BLATTNER, PAULA	4
3020	READING 3	3-2	22	22	22	HAMMEN, KAYLA	4
3020	READING 3	3-3	21	21	21	KEMPFERT, CHARLOTTE	4
3020	READING 3	3-4	23	23	23	MATTSON, LAUREN	4
3022	LANGUAGE ARTS 3	3-1	21	21	21	BLATTNER, PAULA	14
3022	LANGUAGE ARTS 3	3-2	22	22	22	HAMMEN, KAYLA	14
3022	LANGUAGE ARTS 3	3-3	21	21	21	KEMPFERT, CHARLOTTE	14
3022	LANGUAGE ARTS 3	3-4	23	23	23	MATTSON, LAUREN	14
3025	WRITING 3	3-1	21	21	21	BLATTNER, PAULA	5
3025	WRITING 3	3-2	22	22	22	HAMMEN, KAYLA	5
3025	WRITING 3	3-3	21	21	21	KEMPFERT, CHARLOTTE	5
3025	WRITING 3	3-4	23	23	23	MATTSON, LAUREN	5
3030	MATH 3	3-1	21	21	21	BLATTNER, PAULA	7
3030	MATH 3	3-2	22	22	22	HAMMEN, KAYLA	7
3030	MATH 3	3-3	21	21	21	KEMPFERT, CHARLOTTE	7
3030	MATH 3	3-4	23	23	23	MATTSON, LAUREN	7
3060	SCI/SS/HLTH 3	3-1	21	21	21	BLATTNER, PAULA	8
3060	SCI/SS/HLTH 3	3-2	22	22	22	HAMMEN, KAYLA	8
3060	SCI/SS/HLTH 3	3-3	21	21	21	KEMPFERT, CHARLOTTE	8
3060	SCI/SS/HLTH 3	3-4	23	23	23	MATTSON, LAUREN	8
3RD	3RD GRADE	3-1	21	21	21	BLATTNER, PAULA	1
3RD	3RD GRADE	3-2	22	22	22	HAMMEN, KAYLA	1
3RD	3RD GRADE	3-3	21	21	21	KEMPFERT, CHARLOTTE	1
3RD	3RD GRADE	3-4	23	23	23	MATTSON, LAUREN	1
4020	READING 4	4-1	24	24	24	COOAN, KRISTEN	4
4020	READING 4	4-2	23	23	23	JUDGE, SUSAN	4
4020	READING 4	4-3	22	22	22	LEMANIAC, BRITTANY	4
4022	LANGUAGE ARTS 4	4-1	24	24	24	COOAN, KRISTEN	14
4022	LANGUAGE ARTS 4	4-2	23	23	23	JUDGE, SUSAN	14
4022	LANGUAGE ARTS 4	4-3	22	22	22	LEMANIAC, BRITTANY	14

Hudson School District Elementary Course Offerings 2018-19

Course	Short Description	Sec	Enrl T1	Enrl T2	Enrl T3	Teacher	Dsp Prd
4025	WRITING 4	4-1	24	24	24	COOAN, KRISTEN	5
4025	WRITING 4	4-2	23	23	23	JUDGE, SUSAN	5
4025	WRITING 4	4-3	22	22	22	LEMANIAK, BRITTANY	5
4030	MATH 4	4-1	24	24	24	COOAN, KRISTEN	7
4030	MATH 4	4-2	23	23	23	JUDGE, SUSAN	7
4030	MATH 4	4-3	22	22	22	LEMANIAK, BRITTANY	7
4060	SCI/SS/HLTH 4	4-1	24	24	24	COOAN, KRISTEN	8
4060	SCI/SS/HLTH 4	4-2	23	23	23	JUDGE, SUSAN	8
4060	SCI/SS/HLTH 4	4-3	22	22	22	LEMANIAK, BRITTANY	8
4TH	4TH GRADE	4-1	24	24	24	COOAN, KRISTEN	1
4TH	4TH GRADE	4-2	23	23	23	JUDGE, SUSAN	1
4TH	4TH GRADE	4-3	22	22	22	LEMANIAK, BRITTANY	1
5020	READING 5	5-1	23	23	23	DAVIS, AMY	4
5020	READING 5	5-2	24	24	24	SCHEWE, CATHY	4
5020	READING 5	5-3	23	23	23	SCHWERTEL, LINDA	4
5020	READING 5	5-4	24	24	24	SHIMON, HEIDI	4
5022	LANGUAGE ARTS 5	5-1	23	23	23	DAVIS, AMY	14
5022	LANGUAGE ARTS 5	5-2	24	24	24	SCHEWE, CATHY	14
5022	LANGUAGE ARTS 5	5-3	23	23	23	SCHWERTEL, LINDA	14
5022	LANGUAGE ARTS 5	5-4	24	24	24	SHIMON, HEIDI	14
5025	WRITING 5	5-1	23	23	23	DAVIS, AMY	5
5025	WRITING 5	5-2	24	24	24	SCHEWE, CATHY	5
5025	WRITING 5	5-3	23	23	23	SCHWERTEL, LINDA	5
5025	WRITING 5	5-4	24	24	24	SHIMON, HEIDI	5
5030	MATH 5	5-1	23	23	23	DAVIS, AMY	7
5030	MATH 5	5-2	24	24	24	SCHEWE, CATHY	7
5030	MATH 5	5-3	23	23	23	SCHWERTEL, LINDA	7
5030	MATH 5	5-4	24	24	24	SHIMON, HEIDI	7
5060	SCI/SS/HLTH 5	5-1	23	23	23	DAVIS, AMY	8
5060	SCI/SS/HLTH 5	5-2	24	24	24	SCHEWE, CATHY	8
5060	SCI/SS/HLTH 5	5-3	23	23	23	SCHWERTEL, LINDA	8
5060	SCI/SS/HLTH 5	5-4	24	24	24	SHIMON, HEIDI	8
5TH	5TH GRADE	5-1	23	23	23	DAVIS, AMY	1
5TH	5TH GRADE	5-2	24	24	24	SCHEWE, CATHY	1
5TH	5TH GRADE	5-3	23	23	23	SCHWERTEL, LINDA	1
5TH	5TH GRADE	5-4	24	24	24	SHIMON, HEIDI	1
6001	MEDIA/TECH 1	1-1	20	20	20	MAAS, DAVID W	10
6001	MEDIA/TECH 1	1-2	20	20	20	MAAS, DAVID W	10
6001	MEDIA/TECH 1	1-3	21	21	21	MAAS, DAVID W	10

Hudson School District Elementary Course Offerings 2018-19

Course	Short Description	Sec	Enrl T1	Enrl T2	Enrl T3	Teacher	Dsp Prd
6001	MEDIA/TECH 1	1-4	19	19	19	MAAS, DAVID W	10
6002	MEDIA/TECH 2	2-1	22	22	22	MAAS, DAVID W	10
6002	MEDIA/TECH 2	2-2	21	21	21	MAAS, DAVID W	10
6002	MEDIA/TECH 2	2-3	20	20	20	MAAS, DAVID W	10
6002	MEDIA/TECH 2	2-4	18	18	18	MAAS, DAVID W	10
6003	MEDIA/TECH 3	3-1	21	21	21	MAAS, DAVID W	10
6003	MEDIA/TECH 3	3-2	22	22	22	MAAS, DAVID W	10
6003	MEDIA/TECH 3	3-3	21	21	21	MAAS, DAVID W	10
6003	MEDIA/TECH 3	3-4	23	23	23	MAAS, DAVID W	10
6004	MEDIA/TECH 4	4-1	24	24	24	MAAS, DAVID W	10
6004	MEDIA/TECH 4	4-2	23	23	23	MAAS, DAVID W	10
6004	MEDIA/TECH 4	4-3	22	22	22	MAAS, DAVID W	10
6005	MEDIA/TECH 5	5-1	23	23	23	MAAS, DAVID W	10
6005	MEDIA/TECH 5	5-2	24	24	24	MAAS, DAVID W	10
6005	MEDIA/TECH 5	5-3	23	23	23	MAAS, DAVID W	10
6005	MEDIA/TECH 5	5-4	24	24	24	MAAS, DAVID W	10
7001	PHY ED 1	1-1	20	20	20	CARTER, JOAN M	11
7001	PHY ED 1	1-2	20	20	20	MILLER, JULIA E	11
7001	PHY ED 1	1-3	21	21	21	CARTER, JOAN M	11
7001	PHY ED 1	1-4	19	19	19	CARTER, JOAN M	11
7002	PHY ED 2	2-1	22	22	22	MILLER, JULIA E	11
7002	PHY ED 2	2-2	21	21	21	CARTER, JOAN M	11
7002	PHY ED 2	2-3	20	20	20	CARTER, JOAN M	11
7002	PHY ED 2	2-4	18	18	18	CARTER, JOAN M	11
7003	PHY ED 3	3-1	21	21	21	CARTER, JOAN M	11
7003	PHY ED 3	3-2	22	22	22	MILLER, JULIA E	11
7003	PHY ED 3	3-3	21	21	21	CARTER, JOAN M	11
7003	PHY ED 3	3-4	23	23	23	CARTER, JOAN M	11
7004	PHY ED 4	4-1	24	24	24	CARTER, JOAN M	11
7004	PHY ED 4	4-2	23	23	23	MILLER, JULIA E	11
7004	PHY ED 4	4-3	22	22	22	CARTER, JOAN M	11
7005	PHY ED 5	5-1	23	23	23	MILLER, JULIA E	11
7005	PHY ED 5	5-2	24	24	24	CARTER, JOAN M	11
7005	PHY ED 5	5-3	23	23	23	CARTER, JOAN M	11
7005	PHY ED 5	5-4	24	24	24	CARTER, JOAN M	11
8001	MUSIC 1	1-1	20	20	20	BAUMGARTNER, DANIEL	12
8001	MUSIC 1	1-2	20	20	20	BAUMGARTNER, DANIEL	12
8001	MUSIC 1	1-3	21	21	21	BAUMGARTNER, DANIEL	12
8001	MUSIC 1	1-4	19	19	19	KRASIN, PAUL M	12



Hudson School District Elementary Course Offerings 2018-19

Course	Short Description	Sec	Enrl T1	Enrl T2	Enrl T3	Teacher	Dsp Prd
8002	MUSIC 2	2-1	22	22	22	BAUMGARTNER, DANIEL	12
8002	MUSIC 2	2-2	21	21	21	BAUMGARTNER, DANIEL	12
8002	MUSIC 2	2-3	20	20	20	BAUMGARTNER, DANIEL	12
8002	MUSIC 2	2-4	18	18	18	KRASIN, PAUL M	12
8003	MUSIC 3	3-1	21	21	21	BAUMGARTNER, DANIEL	12
8003	MUSIC 3	3-2	22	22	22	BAUMGARTNER, DANIEL	12
8003	MUSIC 3	3-3	21	21	21	BAUMGARTNER, DANIEL	12
8003	MUSIC 3	3-4	23	23	23	KRASIN, PAUL M	12
8004	MUSIC 4	4-1	24	24	24	BAUMGARTNER, DANIEL	12
8004	MUSIC 4	4-2	23	23	23	BAUMGARTNER, DANIEL	12
8004	MUSIC 4	4-3	22	22	22	BAUMGARTNER, DANIEL	12
8005	MUSIC 5	5-1	23	23	23	BAUMGARTNER, DANIEL	12
8005	MUSIC 5	5-2	24	24	24	BAUMGARTNER, DANIEL	12
8005	MUSIC 5	5-3	23	23	23	BAUMGARTNER, DANIEL	12
8005	MUSIC 5	5-4	24	24	24	KRASIN, PAUL M	12
81004	ORCHESTRA 4	4-1	25	25	25	PETERSON, BRITT	6
81005	ORCHESTRA 5	5-1	25	25	25	PETERSON, BRITT	6
9001	ART 1	1-1	20	20	20	BURAK-GRESMER, CYNTHIA	13
9001	ART 1	1-2	20	20	20	BURAK-GRESMER, CYNTHIA	13
9001	ART 1	1-3	21	21	21	BURAK-GRESMER, CYNTHIA	13
9001	ART 1	1-4	19	19	19	BURAK-GRESMER, CYNTHIA	13
9002	ART 2	2-1	22	22	22	BURAK-GRESMER, CYNTHIA	13
9002	ART 2	2-2	21	21	21	BURAK-GRESMER, CYNTHIA	13
9002	ART 2	2-3	20	20	20	BURAK-GRESMER, CYNTHIA	13
9002	ART 2	2-4	18	18	18	BURAK-GRESMER, CYNTHIA	13
9003	ART 3	3-1	21	21	21	BURAK-GRESMER, CYNTHIA	13
9003	ART 3	3-2	22	22	22	BURAK-GRESMER, CYNTHIA	13
9003	ART 3	3-3	21	21	21	BURAK-GRESMER, CYNTHIA	13
9003	ART 3	3-4	23	23	23	BURAK-GRESMER, CYNTHIA	13
9004	ART 4	4-1	24	24	24	BURAK-GRESMER, CYNTHIA	13
9004	ART 4	4-2	23	23	23	BURAK-GRESMER, CYNTHIA	13
9004	ART 4	4-3	22	22	22	BURAK-GRESMER, CYNTHIA	13
9005	ART 5	5-1	23	23	23	BURAK-GRESMER, CYNTHIA	13
9005	ART 5	5-2	24	24	24	BURAK-GRESMER, CYNTHIA	13
9005	ART 5	5-3	23	23	23	BURAK-GRESMER, CYNTHIA	13
9005	ART 5	5-4	24	24	24	BURAK-GRESMER, CYNTHIA	13
91010	LRN/BEHAV/SS 1	1-1	20	20	20	KLIMEK, GINA	3
91010	LRN/BEHAV/SS 1	1-2	20	20	20	LILA, CHRIS	3
91010	LRN/BEHAV/SS 1	1-3	21	21	21	SCHUETT, BRIDGET	3

Hudson School District Elementary Course Offerings 2018-19

Course	Short Description	Sec	Enrl T1	Enrl T2	Enrl T3	Teacher	Dsp Prd
91010	LRN/BEHAV/SS 1	1-4	19	19	19	WARREN, JULIE	3
92010	LRN/BEHAV/SS 2	2-1	22	22	22	CLAYCOMB, DIANE	3
92010	LRN/BEHAV/SS 2	2-2	21	21	21	KLEPP, BRIEANN	3
92010	LRN/BEHAV/SS 2	2-3	20	20	20	KREIBICH, JODY	3
92010	LRN/BEHAV/SS 2	2-4	18	18	18	WERT, ADAM B	3
93010	LERN/BEHAV/SS 3	3-1	21	21	21	BLATTNER, PAULA	3
93010	LERN/BEHAV/SS 3	3-2	22	22	22	HAMMEN, KAYLA	3
93010	LERN/BEHAV/SS 3	3-3	21	21	21	KEMPFERT, CHARLOTTE	3
93010	LERN/BEHAV/SS 3	3-4	23	23	23	MATTSON, LAUREN	3
94010	LRN/BEHAV/SS 4	4-1	24	24	24	COOAN, KRISTEN	3
94010	LRN/BEHAV/SS 4	4-2	23	23	23	JUDGE, SUSAN	3
94010	LRN/BEHAV/SS 4	4-3	22	22	22	LEMANIAK, BRITTANY	3
95010	LRN/BEHAV/SS 5	5-1	23	23	23	DAVIS, AMY	3
95010	LRN/BEHAV/SS 5	5-2	24	24	24	SCHEWE, CATHY	3
95010	LRN/BEHAV/SS 5	5-3	23	23	23	SCHWERTEL, LINDA	3
95010	LRN/BEHAV/SS 5	5-4	24	24	24	SHIMON, HEIDI	3
99020	READING K	K-1	21	21	21	ANDRACEK, JULIE A	4
99020	READING K	K-2	19	19	19	MERRITT, SUSAN J	4
99020	READING K	K-3	21	21	21	THORSON, NATALIE R	4
99020	READING K	K-4	19	19	19	WIMER, HEATHER J	4
99022	SPK/LISTEN K	K-1	21	21	21	ANDRACEK, JULIE A	14
99022	SPK/LISTEN K	K-2	19	19	19	MERRITT, SUSAN J	14
99022	SPK/LISTEN K	K-3	21	21	21	THORSON, NATALIE R	14
99022	SPK/LISTEN K	K-4	19	19	19	WIMER, HEATHER J	14
99025	WRITING K	K-1	21	21	21	ANDRACEK, JULIE A	5
99025	WRITING K	K-2	19	19	19	MERRITT, SUSAN J	5
99025	WRITING K	K-3	21	21	21	THORSON, NATALIE R	5
99025	WRITING K	K-4	19	19	19	WIMER, HEATHER J	5
99030	MATH K	K-1	21	21	21	ANDRACEK, JULIE A	7
99030	MATH K	K-2	19	19	19	MERRITT, SUSAN J	7
99030	MATH K	K-3	21	21	21	THORSON, NATALIE R	7
99030	MATH K	K-4	19	19	19	WIMER, HEATHER J	7
99040	SCI/SS/HLTH K	K-1	21	21	21	ANDRACEK, JULIE A	8
99040	SCI/SS/HLTH K	K-2	19	19	19	MERRITT, SUSAN J	8
99040	SCI/SS/HLTH K	K-3	21	21	21	THORSON, NATALIE R	8
99040	SCI/SS/HLTH K	K-4	19	19	19	WIMER, HEATHER J	8
996001	MEDIA/TECH K	K-1	21	21	21	MAAS, DAVID W	10
996001	MEDIA/TECH K	K-2	19	19	19	MAAS, DAVID W	10
996001	MEDIA/TECH K	K-3	21	21	21	MAAS, DAVID W	10

Hudson School District Elementary Course Offerings 2018-19

Course	Short Description	Sec	Enrl T1	Enrl T2	Enrl T3	Teacher	Dsp Prd
996001	MEDIA/TECH K	K-4	19	19	19	MAAS, DAVID W	10
997000	PHY ED K	K-1	21	21	21	MILLER, JULIA E	11
997000	PHY ED K	K-2	19	19	19	CARTER, JOAN M	11
997000	PHY ED K	K-3	21	21	21	CARTER, JOAN M	11
997000	PHY ED K	K-4	19	19	19	CARTER, JOAN M	11
998000	MUSIC K	K-1	21	21	21	BAUMGARTNER, DANIEL	12
998000	MUSIC K	K-2	19	19	19	BAUMGARTNER, DANIEL	12
998000	MUSIC K	K-3	21	21	21	BAUMGARTNER, DANIEL	12
998000	MUSIC K	K-4	19	19	19	KRASIN, PAUL M	12
999000	ART K	K-1	21	21	21	BURAK-GRESMER, CYNTHIA	13
999000	ART K	K-2	19	19	19	BURAK-GRESMER, CYNTHIA	13
999000	ART K	K-3	21	21	21	BURAK-GRESMER, CYNTHIA	13
999000	ART K	K-4	19	19	19	BURAK-GRESMER, CYNTHIA	13
999010	LRN/BEHAV/SS K	K-1	21	21	21	ANDRACEK, JULIE A	3
999010	LRN/BEHAV/SS K	K-2	19	19	19	MERRITT, SUSAN J	3
999010	LRN/BEHAV/SS K	K-3	21	21	21	THORSON, NATALIE R	3
999010	LRN/BEHAV/SS K	K-4	19	19	19	WIMER, HEATHER J	3
KIND	KINDERGARTEN	K-1	21	21	21	ANDRACEK, JULIE A	1
KIND	KINDERGARTEN	K-2	19	19	19	MERRITT, SUSAN J	1
KIND	KINDERGARTEN	K-3	21	21	21	THORSON, NATALIE R	1
KIND	KINDERGARTEN	K-4	19	19	19	WIMER, HEATHER J	1



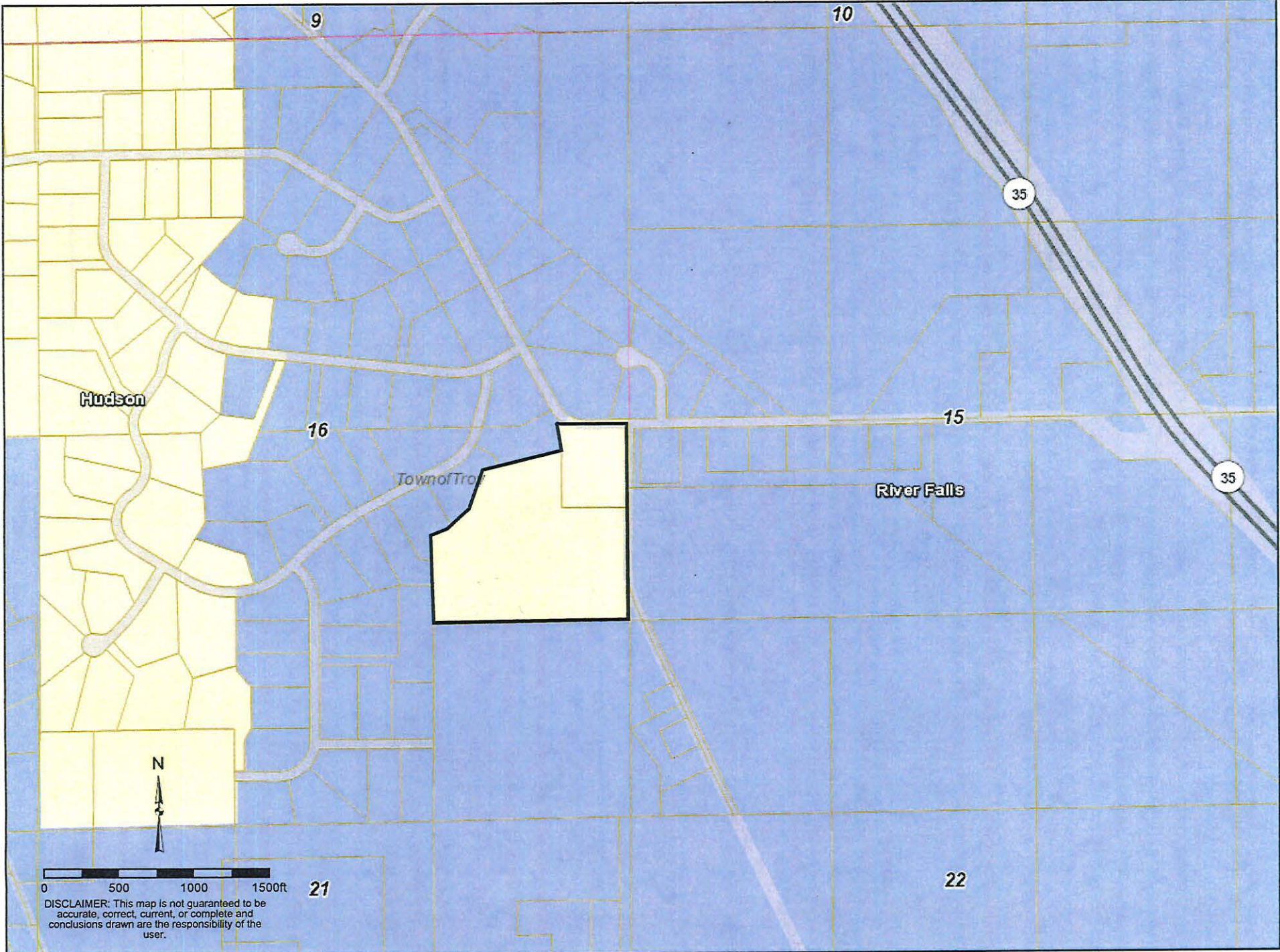

DISCLAIMER: This map is not guaranteed to be accurate, correct, current, or complete and conclusions drawn are the responsibility of the user.

21

22



**MATERIALS  
FROM  
ATTACHING  
DISTRICT**





Testimony from Jamie Benson, District Administrator, River Falls School District, provided to the Department of Public Instruction on May 10, 2019:

*The School District of River Falls Board of Education previously voted to "approve" this boundary appeal. We continue to maintain the same position.*



19-10



**SCHOOL BOARD OF THE SCHOOL DISTRICT OF RIVER FALLS**

**ORDER ALTERING SCHOOL DISTRICT BOUNDARY LINES**

The School Board of the School District of River Falls under the authority of Wis. Stat. sec. 117.12 and in compliance with a resolution adopted at a meeting of said School Board held at the District Office, 852 E. Division Street, River Falls, Wisconsin 54022 at 7:00 p.m. on the 18th day of February 2019, hereby orders that the parcels of property more particularly described on Exhibit A, a copy of which is attached hereto and incorporated herein by reference, to be detached from the School District of Hudson and attached to the School District of River Falls.

This order shall take effect on July 1, 2019.

SCHOOL BOARD OF THE SCHOOL DISTRICT OF RIVER FALLS

Date 2/18/2019

Stacy Johnson Nye

Ellen J. Winters

Wise Miller

Amy M Halvorson

Ramona L. Dreyer

Carl K. Dalfors

Michael Dreyer

Order received by the School District Boundary Appeal Board on \_\_\_\_\_, 2019.

\_\_\_\_\_  
Secretary  
School District Boundary Appeal Board



19-10

**Exhibit A**

The territory proposed to be detached from the Hudson School District and attached to the School District of River Falls is described as follows:

Owner	Description	PIN
Ryan and Heidi Van Nurden	Sec. 16, T28N, R19W, NE SE being CSM 27-6158 Lot 1, Town of Troy, St. Croix County, WI	040-1066-60-0001
Dale Van Nurden	Sec. 16, T28N, R19W, Part of NE SE and NW SE being CSM 27-6158 Lot 2, Town of Troy, St. Croix County, WI	040-1066-60-0002





# **MATERIALS FROM DPI FILE**





## 2017-18 DATA

1. GENERAL INFORMATION	<u>Hudson</u>	<u>River Falls</u>
Type of District	Common	Common
Grades Taught	K-12	K-12
Area in Square Miles	70.89	143.96
CESA	11	11

2. 2016-17 RESIDENT ENROLLMENT	September 2017 Pupil Count		January 2018 Pupil Count		Summer 2017 Pupil Count	
	<u>Hudson</u>	<u>River Falls</u>	<u>Hudson</u>	<u>River Falls</u>	<u>Hudson</u>	<u>River Falls</u>
Summer School F.T.E.					31	24
Pre-K / Kind	633	412	649	433		
Grades 1-12	5,082	2,881	5,081	2,913		
<b>District Total</b>	<b>5,715</b>	<b>3,293</b>	<b>5,730</b>	<b>3,346</b>	<b>31</b>	<b>24</b>

3. 2018-19 ATTENDANCE CENTERS	Total Number of Centers		Total Number of Pupils	
	<u>Hudson</u>	<u>River Falls</u>	<u>Hudson</u>	<u>River Falls</u>
Elementary	7	5	2,642	1,728
M.S./Jr. High	1	1	1,335	796
High Schools	1	2	1,804	1,044
<b>District Total</b>	<b>9</b>	<b>8</b>	<b>5,781</b>	<b>3,568</b>

4. 2016-17 STAFF INFORMATION	(2016-17 Performance Report Data)				
	District F.T.E.		District Pupil/Staff Ratio		
	<u>Hudson</u>	<u>River Falls</u>	<u>Hudson</u>	<u>River Falls</u>	<u>STATE</u>
Licensed Instruction	422.10	224.70	13.00	14.70	12.80
Administrative	22.00	13.00	249.90	254.40	208.00
Aides/Support/Other	310.00	128.90	17.70	25.60	23.20
<b>District Total</b>	<b>754.10</b>	<b>366.60</b>	<b>7.30</b>	<b>9.00</b>	<b>7.90</b>

5. MEMBERSHIP	<u>Hudson</u>	<u>River Falls</u>
(Membership is resident enrollment adjusted for full-time equivalency.)		
2017-18 Membership (Used for 2017-18 October Aid Certification)	5,668	3,299
	5,668	3,299

6. DISTRICT VALUATION INFORMATION	<u>Hudson</u>	<u>River Falls</u>
Spring 2018 Tax Apportionment Value (TIF-OUT Valuation)	4,077,764,473	2,000,473,726
2018 Value Per FTE Member (Using 2017-18 Membership)	719,436	606,388
-----		
Fall 2018 Tax Apportionment Value (TIF-OUT Valuation)	4,228,042,715	2,131,349,451
2018 Value Per FTE Member (Using 2017-18 Membership)	745,950	646,059

<b>7. 2017-18 ANNUAL TOTAL EXPENDITURES</b>		
	<u>Hudson</u>	<u>River Falls</u>
FUND 10 - General	\$62,815,454	\$33,881,283
FUND 30 - Debt Service	\$7,065,199	\$4,215,730
FUND 80 - Community Service	\$0	\$0
<b>Total Expenditures Per Member (Fund 10 + Fund 30)</b> (Using 2017-18 Membership)	<b>\$12,329</b>	<b>\$11,548</b>

<b>8. 2016-17 EQUALIZATION AID</b> (2017-2018 October Certification)		
(Based on 2016-17 Expenditures & Membership)		
	<u>Hudson</u>	<u>River Falls</u>
Equalization Aid*	\$22,558,917	\$16,126,332
Equalization Aid Per/Member	\$3,980.05	\$4,888.25
State Share**	37.58%	48.03%
* Aid total does not reflect revenue limit penalty, if applicable.		
** State share is aid eligibility divided by shared cost.		

<b>9. LONG-TERM INDEBTEDNESS &amp; BORROWING POWER</b>		
(As of June 30, 2017)		
	<u>Hudson</u>	<u>River Falls</u>
Total Potential Borrowing Power	\$407,715,578	\$204,628,142
Long-Term Indebtedness	\$85,195,000	\$25,815,000
Remaining Borrowing Power	\$322,520,578	\$178,813,142
Percent of Borrowing Power Remaining (%)	79.10%	87.38%
(Using 2016 TIF-IN Valuation)		

<b>10. FALL 2018 SCHOOL TAX LEVY</b>		
	<u>Hudson</u>	<u>River Falls</u>
FUND 10 - General	\$35,115,039	\$14,068,152
Non-Referendum Debt	\$0	\$0
FUND 30 - Debt Service	\$7,011,271	\$3,991,823
FUND 40 - Capital Projects Fund	\$0	\$0
FUND 80 - Community Service	\$0	\$150,000
Prior Year Tax Chargebacks	\$0	\$0
<b>Total Tax Levied (ALL FUNDS)</b>	<b>\$42,126,310</b>	<b>\$18,209,975</b>
<b>Total Tax Levy Rate (Mills)</b>	<b>9.96</b>	<b>8.54</b>

<b>11. 2017-18 ACADEMIC COURSE OFFERINGS</b>		
Master teaching schedule for the high school has been provided by each school district. Schedules can be found under each district's tab.		

<b>12. 2016-17 EXTRA-/CO-CURRICULAR (High School)</b> (2015-16 Performance Report Data)		
	<u>Hudson</u>	<u>River Falls</u>
3rd Friday Enrollment (High School)	1793	974
Number of Extra-/Co-Curricular Offerings	54	5
Participation Rate %		
Academic	26.20 %	99.69 %
Athletic	45.30 %	13.35 %
Music	17.80 %	0.00 %

Date: March 5, 2019

To: Ryan and Heidi Van Nurden

From: Janice Zmrazek, School Administration Consultant  
School Management Services, DPI

Subject: Small Territory Detachment; Right to Appeal **File 19-10**

The petition, **file 19-10**, to detach property from the Hudson School District and attach it to the River Falls School District, has been denied. Petitioners whose property detachment requests have been denied have a right to appeal under the provisions of section 117.12(4), Wisconsin statutes.

The law provides that a majority of the electors residing in the territory, or the owners of 50% or more of the territory, may appeal the denial to an appeal panel by filing notice of appeal with the secretary of the School District Boundary Appeal Board **before** the March 15 following the denial. See s.115.01 (13), Wisconsin statutes, for a definition of electors.

The law further provides that the State Superintendent may charge a filing fee for such appeals. The appeal filing fee is \$750.00 – see <https://dpi.wi.gov/sms/school-district-boundary-appeal-board> for the fee schedule.

Enclosed is a form that may be used to file a notice of appeal. The request should be sent to the address noted and must be accompanied by the required filing fee. **The request and required filing fee must be received at the DPI, 125 S. Webster Street in Madison, by 4:30 p.m. on Thursday, March 14.** You may wish to consider Priority Mail or in-person delivery to ensure timely arrival. Materials received after March 14 will be returned as not timely.

If you have any questions, feel free to contact me at (608) 266-2803.

Enclosure  
JZ:dms

---



*Date:* March 27, 2019

*To:* Ryan and Heidi Van Nurden

*From:* Janice Zmrazek, Secretary  
School District Boundary Appeal Board (SDBAB)

*Subject:* Request for SDBAB Review – File 19-10

This memo acknowledges receipt of your request for review by a panel of the School District Boundary Appeal Board (SDBAB) of File 19-10, a petition to detach property from the Hudson School District. We have also received your check in the amount of \$750.00.

SDBAB hearings are generally held during May so that final orders may be issued by June 15. In order for us to try to accommodate your schedule, please inform us by Friday, **April 5** which of the following dates you would be available to come to Madison where your appeal will be heard: May 7, 8, 23, 29, or 30.

Hearings are typically held between 8:30 a.m. and 4:00 p.m. Hearings generally take between two and four hours and two or three may be scheduled on the same day. We will do our best to schedule the hearing for a day you are available, but cannot guarantee that will occur. **When the hearing schedule is finalized, you will be notified in writing of the date, time and location of your hearing before the SDBAB panel.** You may send a representative or written information if you will be unable to appear in person.

Enclosed is a summary of the hearing procedures. This document indicates that petitioners have the right to submit materials that will be included in a packet that is provided to the SDBAB members and district representatives approximately one week before the hearing. If you plan to submit such material, you may wish to assemble it as soon as is convenient and **mail eight (8) copies to my attention.** You may also bring material (8 copies) on the day of the hearing. Presentations using digital files may also be possible if you bring your own computer. Additional information regarding materials and presentations will be provided when notice of the hearing date is sent.

A copy of the document describing the hearing procedures can also be found at <http://dpi.wi.gov/sms/school-district-boundary-appeal-board/hearing>. If you have any questions about the hearing or the procedures, please contact me at (608) 266-2803, [janice.zmrazek@dpi.wi.gov](mailto:janice.zmrazek@dpi.wi.gov) or Diane Sullivan at (608) 267-9248, [diane.sullivan@dpi.wi.gov](mailto:diane.sullivan@dpi.wi.gov). Materials may be sent to my attention at DPI, P.O. Box 7841, Madison, WI 53707-7841.

JZ:dms  
Enclosure



*Date:* March 27, 2019

*To:* Carrie Whitacre, Clerk, Hudson School District  
Alan Tuchtenhagen, Clerk, River Falls School District

*From:* Janice Zmrazek, Secretary  
School District Boundary Appeal Board

*Subject:* School District Boundary Appeal Board Hearing, **File #19-10**

A request for review of File #19-10, a petition to detach territory from the Hudson School District and attach it to the River Falls School District, has been filed with the Secretary of the School District Boundary Appeal Board (SDBAB) and is enclosed for your information. The petitioner has paid the required \$750 filing fee.

SDBAB hearings are generally held in May so that final orders may be issued by June 15. In order for us to try to establish hearing dates most convenient to the schedules of all participants, please inform us by **April 5** which of the following dates a representative from your district would be available to come to Madison where the appeal will be heard: May 7, 8, 23, 29, or 30.

Hearings are typically scheduled between 8:30 am and 4:00 pm. Hearings generally take between two and four hours and two or three may be scheduled on the same day. We will do our best to schedule the hearing for a day a district representative is available, but cannot guarantee that will occur. **When the hearing schedule is finalized the district will be notified, in writing, of the date, time and location.** If no district representative is available to attend on that day, written information may be submitted.

PI 2.04, Wisconsin Administrative Code, directs that the **clerk of the school board of an affected school district** shall submit the following materials to the Secretary of the School District Boundary Appeal Board at the Department of Public Instruction (DPI):

1. A certified copy of any resolution related to any reorganization proceeding under Chapter 117, Wis. Stats. **(If a resolution has already been sent to the DPI, it is not necessary to send another copy.)**
2. Any reorganization order filed as required under sec. 117.17, Wis. Stats. **(If there is no reorganization order or a reorganization order has already been sent to the DPI, it is not necessary to provide a copy.)**
3. A copy of the notice of any school board hearing on a petition or a resolution for reorganization; transcribed minutes, transcribed stenographic record, or transcribed electronic recording of hearing; and, a correct copy of all exhibits and data submitted at the hearing. If the hearing was a joint hearing, the clerk of the school board from which said territory is proposed to be detached shall submit the information.
4. Any written statement of facts and other relevant matters relating to a proposed reorganization.

**Both districts** are also asked to provide the following two items:

5. A class schedule showing the course offerings available in the school or schools that the children of the petitioners attend or would attend. Generally this is a two to three page summary - see the enclosed example.
6. School district map clearly indicating the location of properties under appeal.

These materials and summary information prepared by the department from district data already on file will be sent in advance of the hearing to the SDBAB panel members, the petitioners, and other district representatives.

The required materials are needed no later than two weeks before the scheduled hearing. Though we have not yet finalized hearing dates, your district may wish to assemble the materials described above and submit them as soon as is convenient. Please **submit eight (8) copies** of the requested information **collated, but not stapled**, in the following order:

- A copy of the resolution . . . (#1 above)
- A copy of the reorganization order . . . (#2 above)
- A copy of the notice . . . (#3 above)
- Any written statement of facts . . . (#4 above)
- Class or teacher schedule for the relevant school(s) . . . (#5 above)
- School district map indicating location of properties under appeal . . . (#6 above)

Please send the materials to:

Secretary, School District Boundary Appeal Board  
Department of Public Instruction  
P.O. Box 7841  
Madison, WI 53707-7841

Your prompt response will ensure that the panel members will have sufficient time before the hearing to read and review the material. The panel will deliberate and make its decision immediately after the conclusion of the testimony and any rebuttal that is presented on the day the hearing is held.

You may also bring materials on the day of the hearing. If you choose to do so, you must also provide eight (8) collated copies 30 minutes prior to the start of the hearing. Presentations using digital materials may also be possible if you bring your own computer.

Additional information about the SDBAB panel hearing process can be found at <http://dpi.wi.gov/sms/school-district-boundary-appeal-board/hearing>. If you have any questions about the hearing or the procedures, please contact me at (608) 266-2803, [janice.zmrazek@dpi.wi.gov](mailto:janice.zmrazek@dpi.wi.gov) or Diane Sullivan at (608) 267-9248, [diane.sullivan@dpi.wi.gov](mailto:diane.sullivan@dpi.wi.gov).

Enclosures

cc: Nick Ouellette, District Administrator, Hudson School District  
James Benson, District Administrator, River Falls School District



## Public Notice of Open Meeting

STATE OF WISCONSIN  
DEPARTMENT OF PUBLIC INSTRUCTION  
SCHOOL DISTRICT BOUNDARY APPEAL BOARD HEARING

**TIME** 12:30 PM

**DATE** 5/29/2019

**LOCATION** GEF 3 - Room P41  
125 South Webster Street  
Madison

**PURPOSE** School District Boundary Appeal No. 2019-10

Hudson School District  
River Falls School District

The School District Boundary Appeal Panel will meet to hear testimony and take action on the proposed reorganization of territory, as provided under Wis. Stat. sec. 117.12(4).

**FURTHER  
INFORMATION** Janice Zmrazek, Secretary  
School District Boundary Appeal Board  
(608) 266-2803

*This meeting site is accessible to persons with physical disabilities. Any person requiring other special accommodations because of a disability should contact Diane Sullivan at (608) 267-9248 in advance of the hearing date.*

g:\reorg\appeals\openmtg\mergeopenmtg\_2019.doc



# Chronology of Events - Petition for School District Reorganization School District Boundary Appeal Board Panel- 2018-19 Wisconsin Department of Public Instruction

**FILE #** 19-10  
**PETITIONER** Ryan and Heidi Van Nurden  
**DETACHING DISTRICT** Hudson  
**ATTACHING DISTRICT** River Falls

12/27/2018 The detaching district received the petition.  
2/11/2019 The school board of the detaching district denied the reorganization.  
3/18/2019 The school board of the attaching district approved the reorganization.  
3/5/2019 A notice of denial was mailed to the petitioner.  
3/11/2019 A request for appeal was received at the DPI.  
5/29/2019 This hearing is taking place at the Department of Public Instruction in the GEF 3 office building in Madison, Wisconsin.

**TIME** 12:30 PM  
**LOCATION** GEF 3 - Room P41

**Number of students residing  
in area under appeal:** 0

Source of Information: Official documents filed with the Secretary of the School District Boundary Appeal Board by the school districts, minutes of school board hearings, if held; documents and reports submitted by the school districts.

Official File: Available from the Secretary of the School District Boundary Appeal Board in advance of, or at the time of, the School District Boundary Appeal Board hearing.

Financial information about the districts can be found in the DPI material section of the appeal packets.



March 8, 2019

School District Boundary Appeal Board  
125 South Webster Street  
Madison, WI 53703

Pursuant to PI 2.05(4), Wis. Admin. Code, I hereby appoint Janice Zmrazek secretary of the School District Boundary Appeal Board. In this capacity, Ms. Zmrazek will serve as chair of the School District Boundary Appeal Board Panel.

Tricia Collins and Mike Bormett are also authorized to chair School District Boundary Appeal Board hearings.

Sincerely,



Carolyn Stanford Taylor  
State Superintendent

ds



**SUBCHAPTER II**  
**STATE SUPERINTENDENT OF PUBLIC INSTRUCTION**

115.28 General duties. The state superintendent shall:

(1) **GENERAL SUPERVISION.** Ascertain the condition of the public schools, stimulate interest in education and spread as widely as possible a knowledge of the means and methods which may be employed to improve the schools.

(2) **SECTARIANISM.** Exclude all sectarian books and instruction from the public schools.

(3) **SUPERVISION OF SCHOOLS.** Supervise and inspect the public schools and day schools for children with disabilities, advise the principals and local authorities thereof and give assistance in organizing such schools.

(3m) **SUPERVISION OF COOPERATIVE EDUCATIONAL SERVICE AGENCIES; RULES.** (a) Supervise and audit the receipts and expenditures of the cooperative educational service agencies, conduct program review of the agencies, supervise boundary reorganization where necessary, advise the administrators of the agencies and provide assistance in organizing the agencies throughout the state.

(b) Promulgate rules establishing procedures for the reorganization of cooperative educational service agencies and boundary appeals.

(4) **PUBLIC INFORMATION.** By reports, bulletins, circulars, correspondence and public addresses, give the public information upon the different methods of school organization and management and the subject of education generally.

(5) **APPEALS.** Examine and determine all appeals which by law are made to the state superintendent and prescribe rules of practice in respect thereto, not inconsistent with law.

(6) **ANNUAL CONVENTIONS.** Annually, hold conventions of school district administrators, supervisors and agency coordinators.





**117.15 Criteria for school district reorganizations.** In making any decision under ss. 117.08 to 117.132, a school board, the board and an appeal panel shall consider the following factors as they affect the educational welfare of all of the children residing in all of the affected school districts, and may consider other appropriate factors:

(1) The geographical and topographical characteristics of the affected school districts, including the estimated travel time to and from school for pupils in the school districts.

(2) The educational needs of all of the children residing in the affected school districts, the educational programs currently offered by each affected school district and the ability and commitment of each school district to meet those needs and continue to offer those educational programs.

(2m) If territory is proposed to be detached from one school district and attached to an adjoining school district or proposed to be included in a new school district under s. 117.105, whether the proposed detachment will have any adverse effect on the program currently offered by the school district from which the territory is proposed to be detached, including both curricular and extracurricular aspects of that program.

(3) The testimony of and written statements filed by the residents of the affected school districts.

(4) The estimated fiscal effect of the proposed reorganization on the affected school districts, including the effect of the apportionment of assets and liabilities.

(5) Whether the proposed reorganization will make any part of a school district's territory noncontiguous.

(6) The socioeconomic level and racial composition of the pupils who reside or will reside in territory proposed to be detached from one school district and attached to an adjoining school district, in territory proposed to be included in a new school district under s. 117.105 or in school districts proposed to be consolidated or in a school district proposed to be dissolved; the proportion of the pupils who reside in such territory who are children at risk, as defined under s. 118.153(1)(a); and the effect that the pupils described in this paragraph will have on the present and future socioeconomic level and racial composition of the affected school districts and on the proportion of the affected school districts' enrollments that will be children at risk.

(7) The results of any referendum held under s. 117.10.

